

(A1)ROUND ALLEN HEAD M12X130L PARTIAL THREAD QTY.4

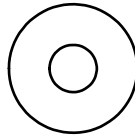

(B1) LOCK NUT M12 QTY.4



(C1)M12(I.D.)FLAT WASHER Ø34 QTY.6



(C2)SPRING WASHER M12 QTY.4

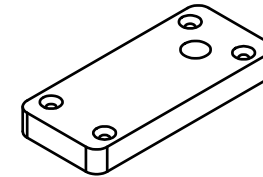

D1.RUBBER PAD(9310-123)-----[2PCS]

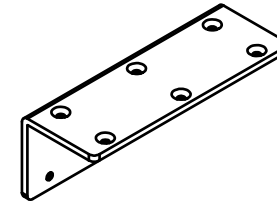

D2.RUBBER PAD(9310-124)-----[2PCS]

A [1SET]

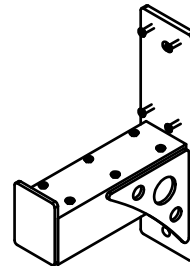

B [1SET]

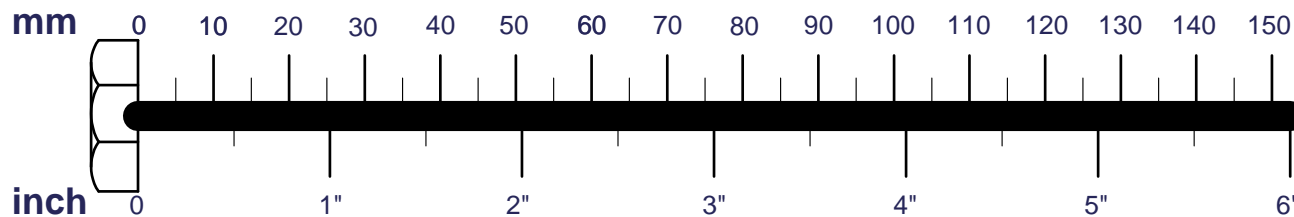
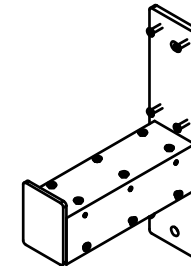

#Please tighten the screw after all parts assembled.
or please tighten all screws after all parts joint together

