

FUNCTION MACHINE

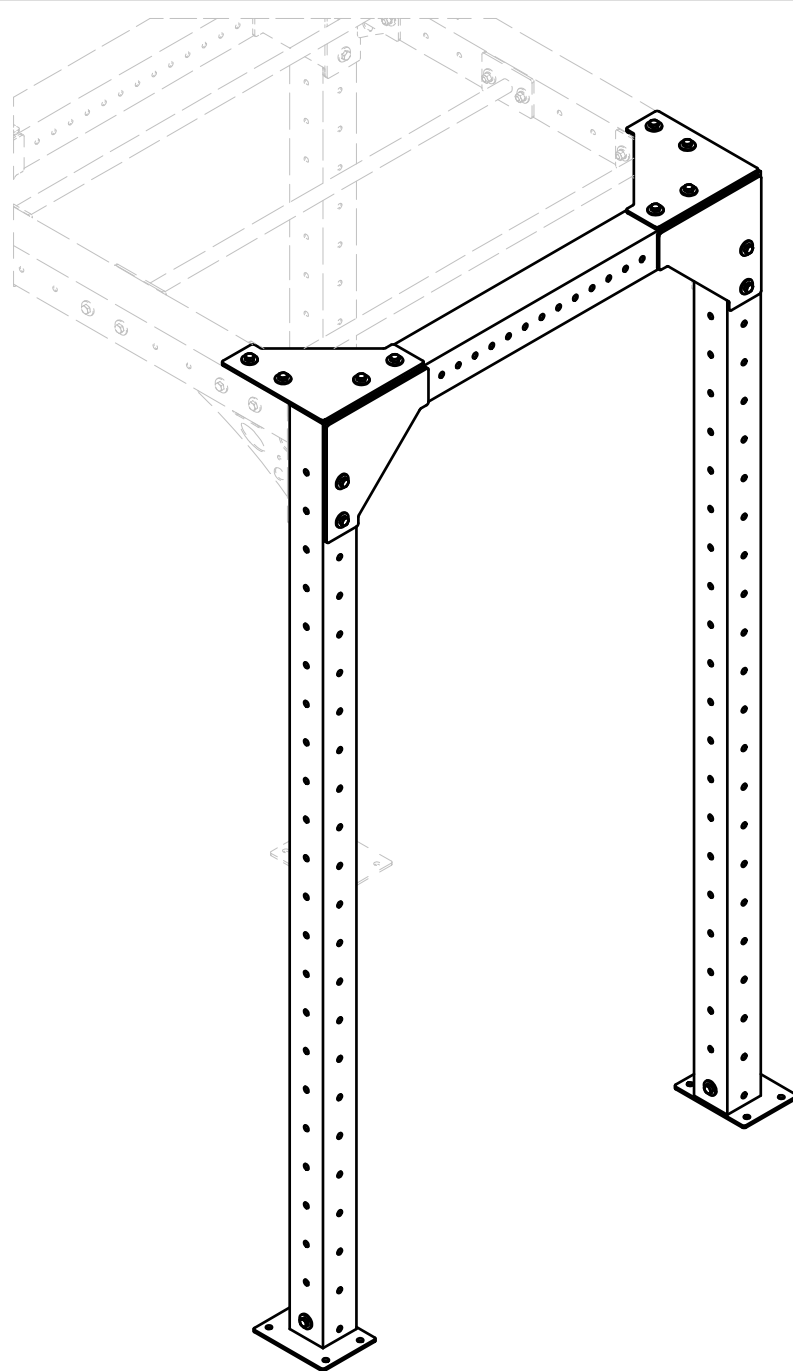

JOONG CHENN INDUSTRY CO., LTD.

Sales Office:

3F28, No.5, Shin-Yi Rd., Sec. 5, Taipei, Taiwan 110 R.O.C.

Tel: 886-2-27209980

Fax: 886-2-27229750

www.steelflexfitness.com

FMK6

OWNER'S MANUAL

FMK6 ASSEMBLY INSTRUCTIONS

HARDWARE ILLUSTRATION

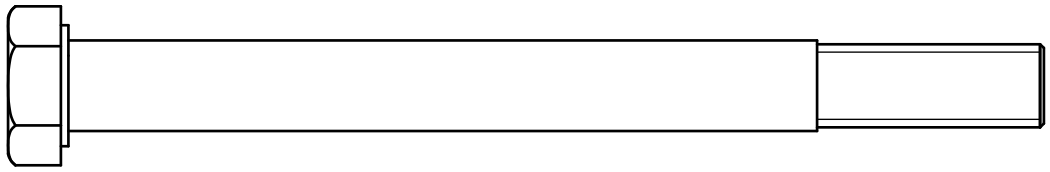
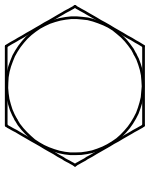

(A1)HEX BOLT M12X130L PARTIAL THREAD QTY.8

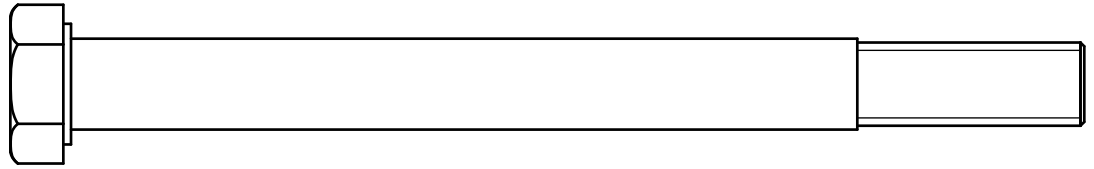
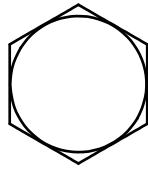

(A2)HEX BOLT M12X135L PARTIAL THREAD QTY.8

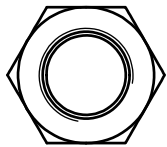

(B1)LOCK NUT M12 QTY.16

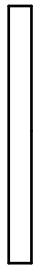
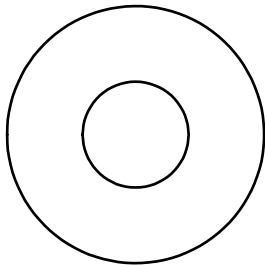

(C1)M12(I.D.)FLAT WASHER Ø34 QTY.32

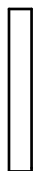
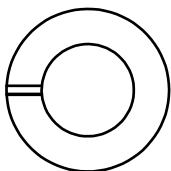

(C2)SPRING WASHER M12 QTY.16

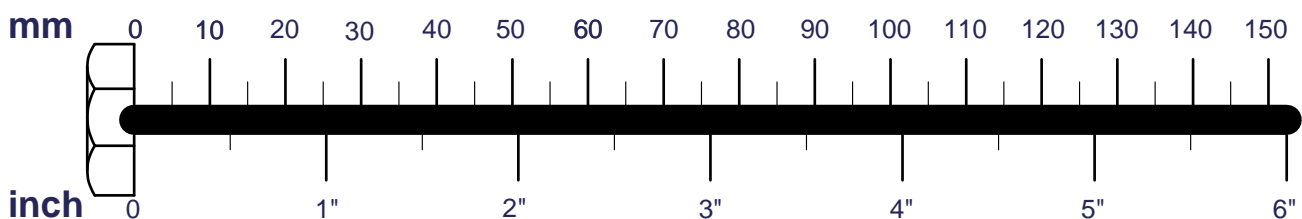

FMK6 ASSEMBLY INSTRUCTIONS

PARTS ILLUSTRATION SHEET

A [1SET]

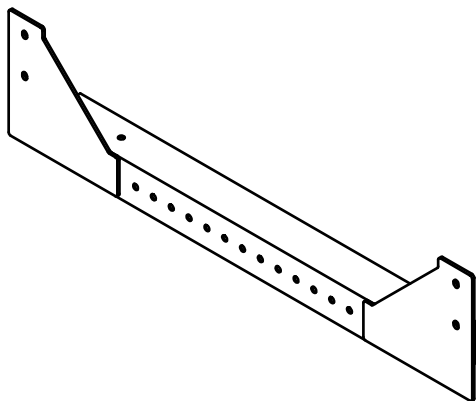

B [2SET]

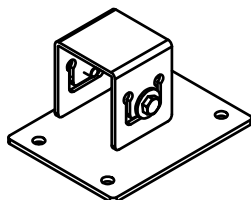

C [2PCS]
10FMK6-01

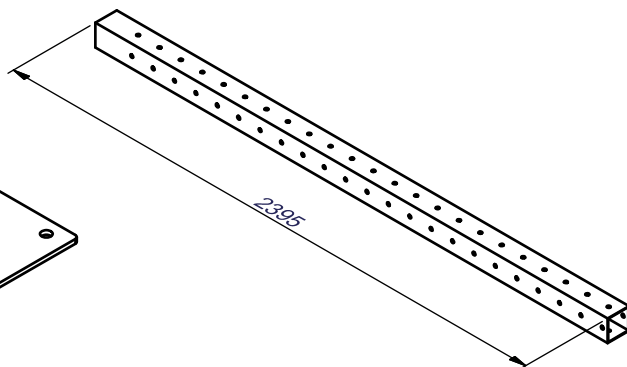

D [2PCS]
8360-176

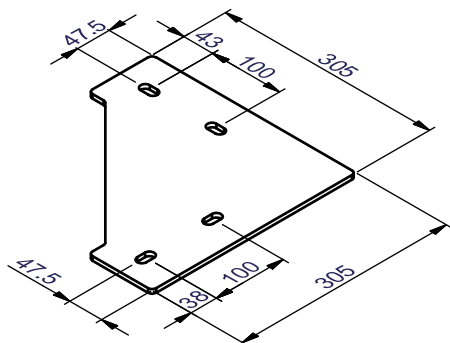

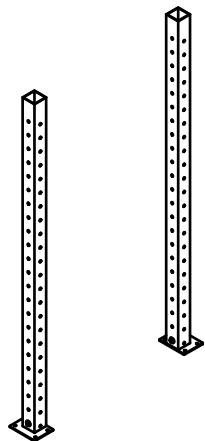

Above shows STEP 1
assembled and completed

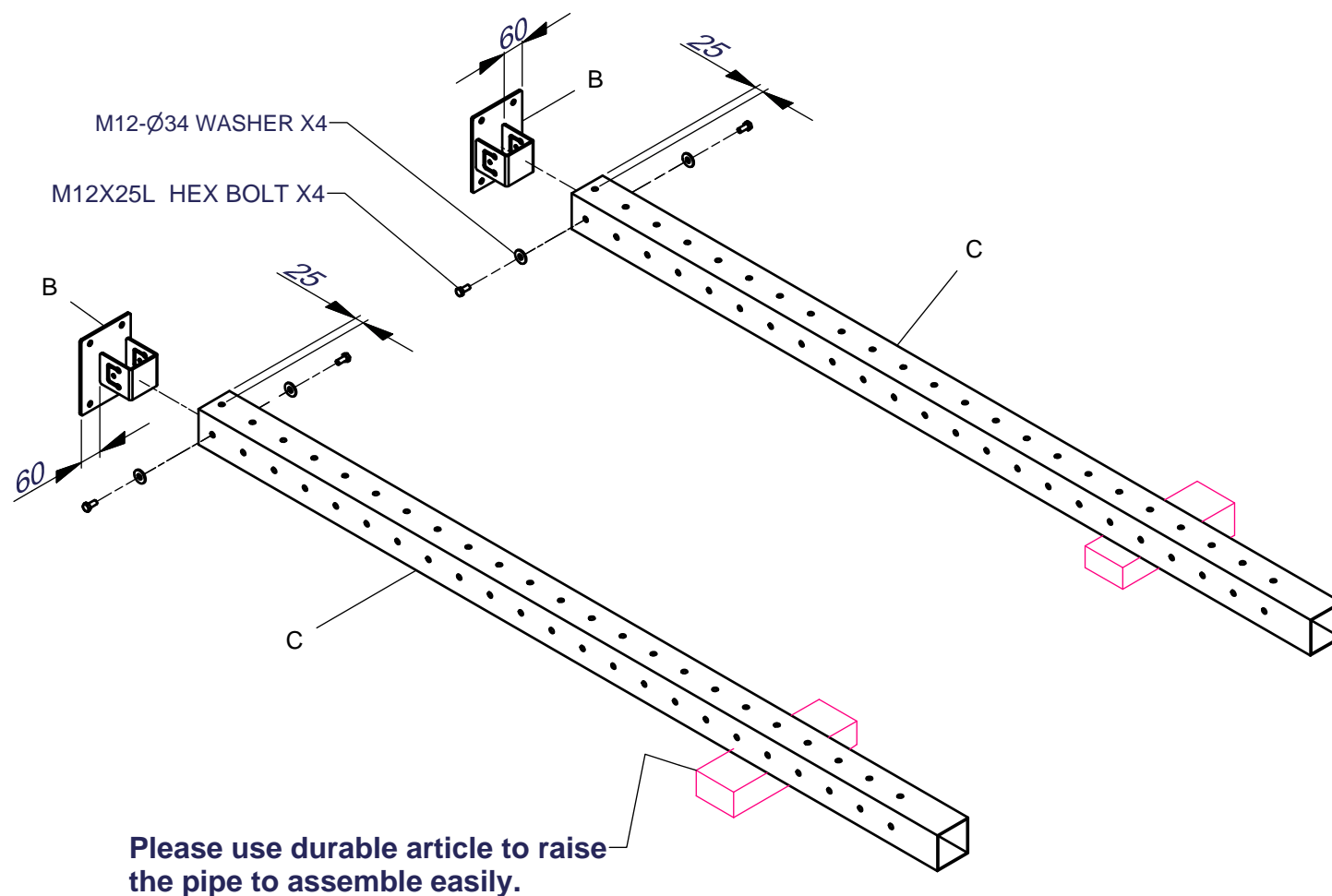

#Please tighten the screw after all parts assembled.
or please tighten all screws after all parts joint together

FMK6 ASSEMBLY INSTRUCTIONS

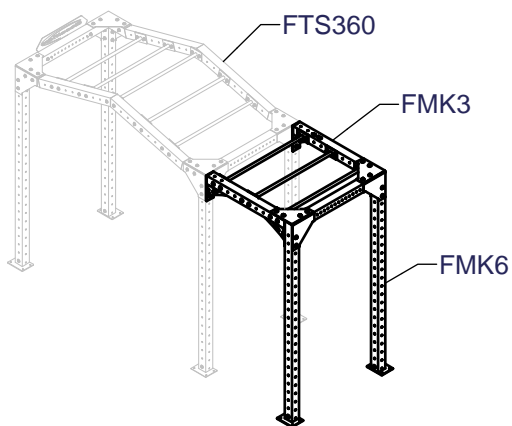

Above shows connect to FMK3 assembled and completed

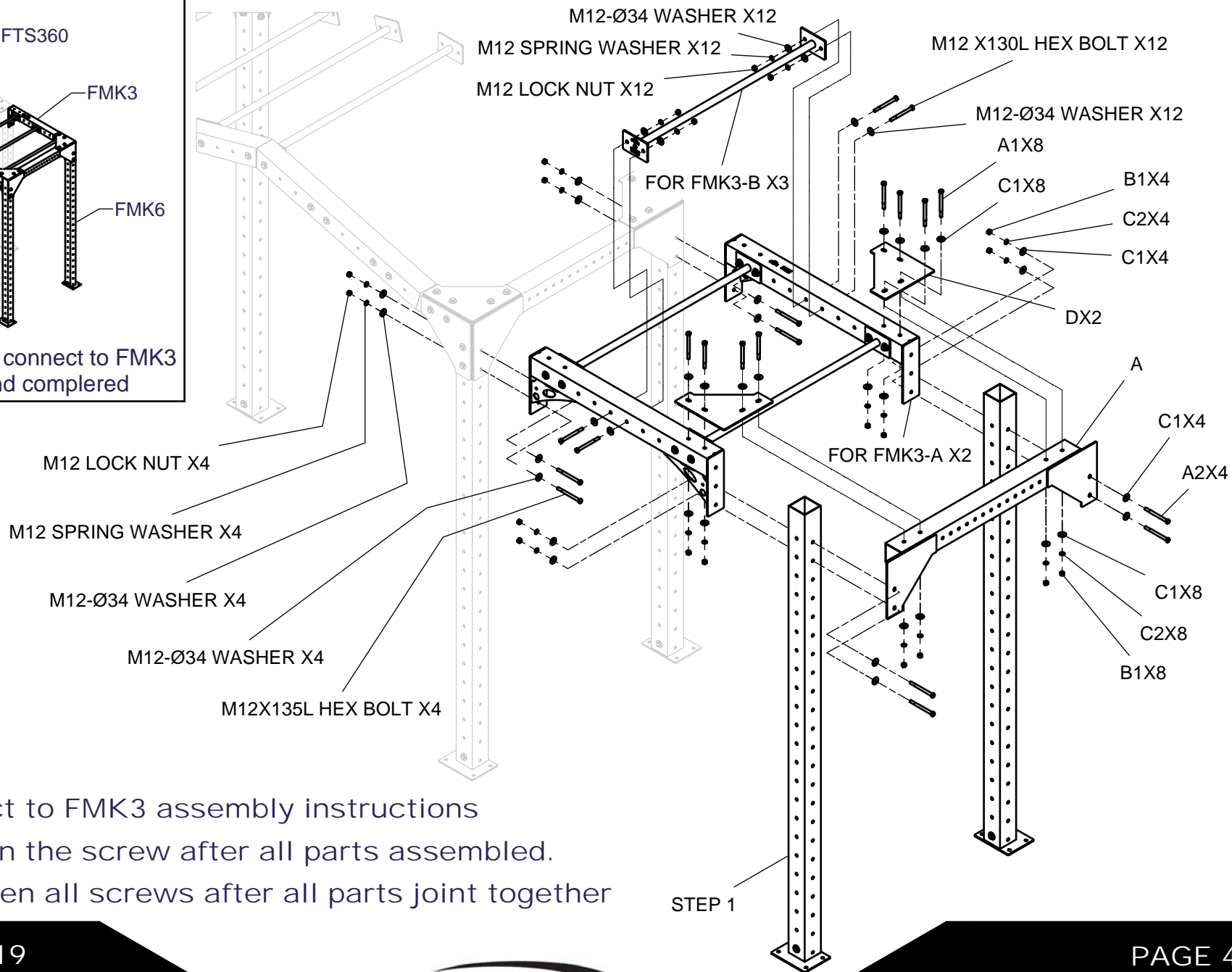

#FMK6 connect to FMK3 assembly instructions
 #Please tighten the screw after all parts assembled.
 or please tighten all screws after all parts joint together

FMK6 ASSEMBLY INSTRUCTIONS

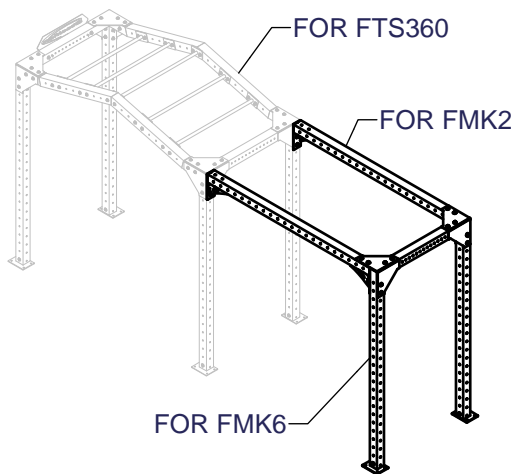

Above shows connect to FMK2
assembled and completed

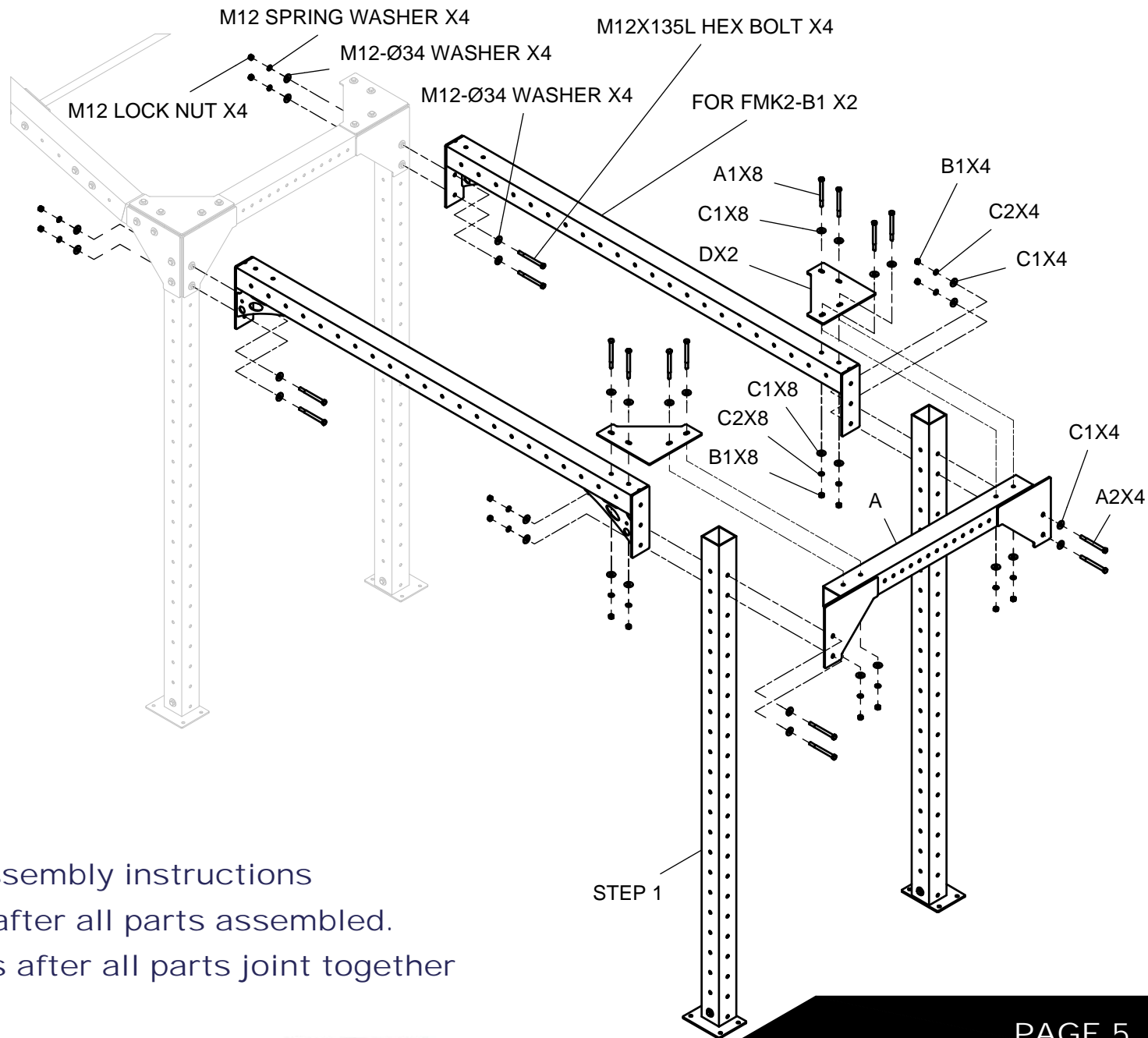

#FMK6 connect to FMK2 assembly instructions
#Please tighten the screw after all parts assembled.
or please tighten all screws after all parts joint together

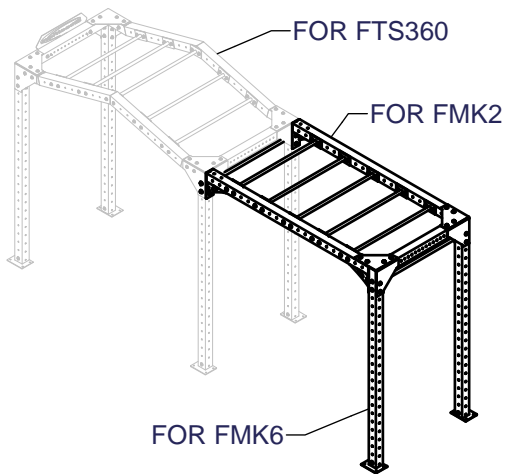

Above shows connect to FMK2
assembled and completed

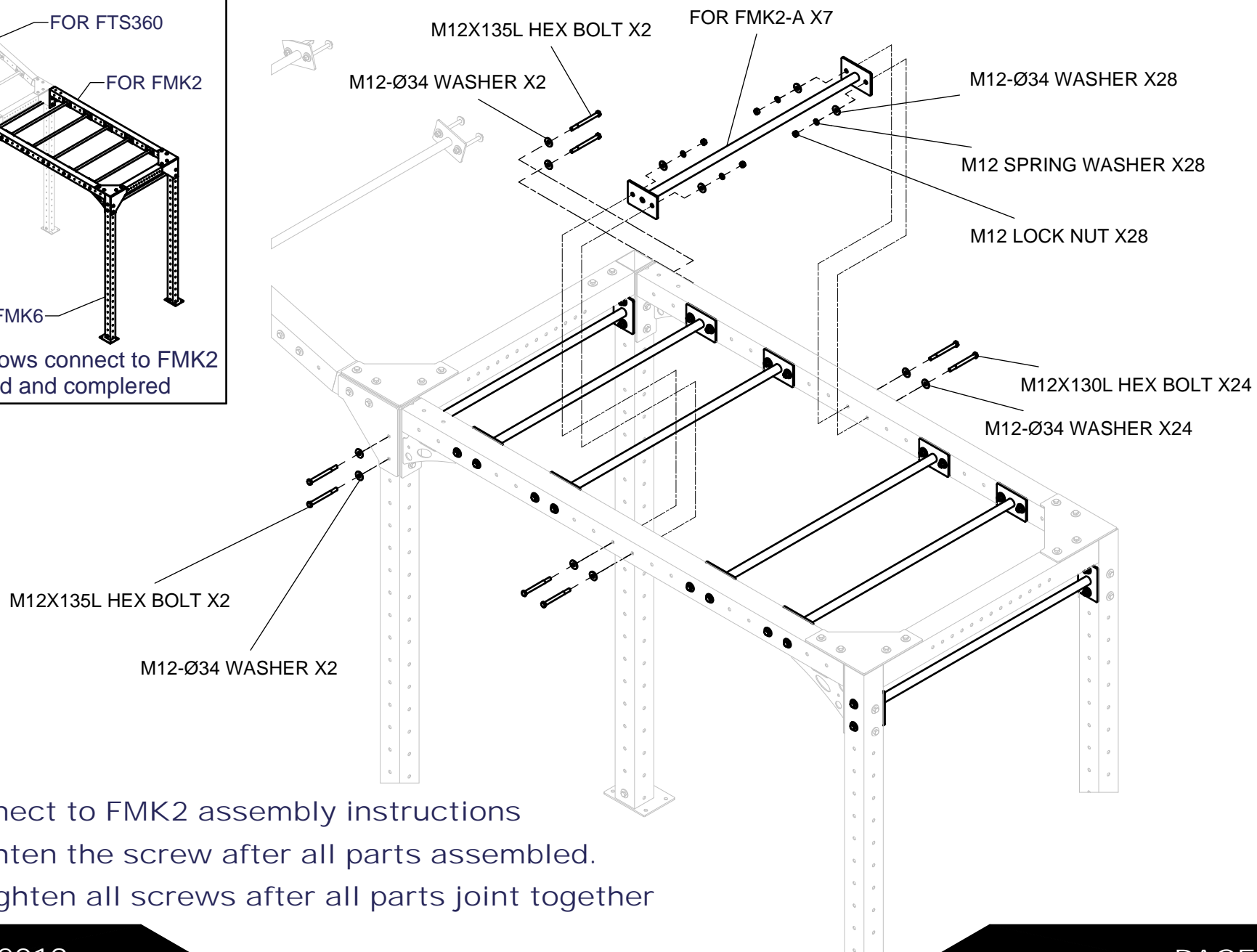

#FMK6 connect to FMK2 assembly instructions

#Please tighten the screw after all parts assembled.

or please tighten all screws after all parts joint together