

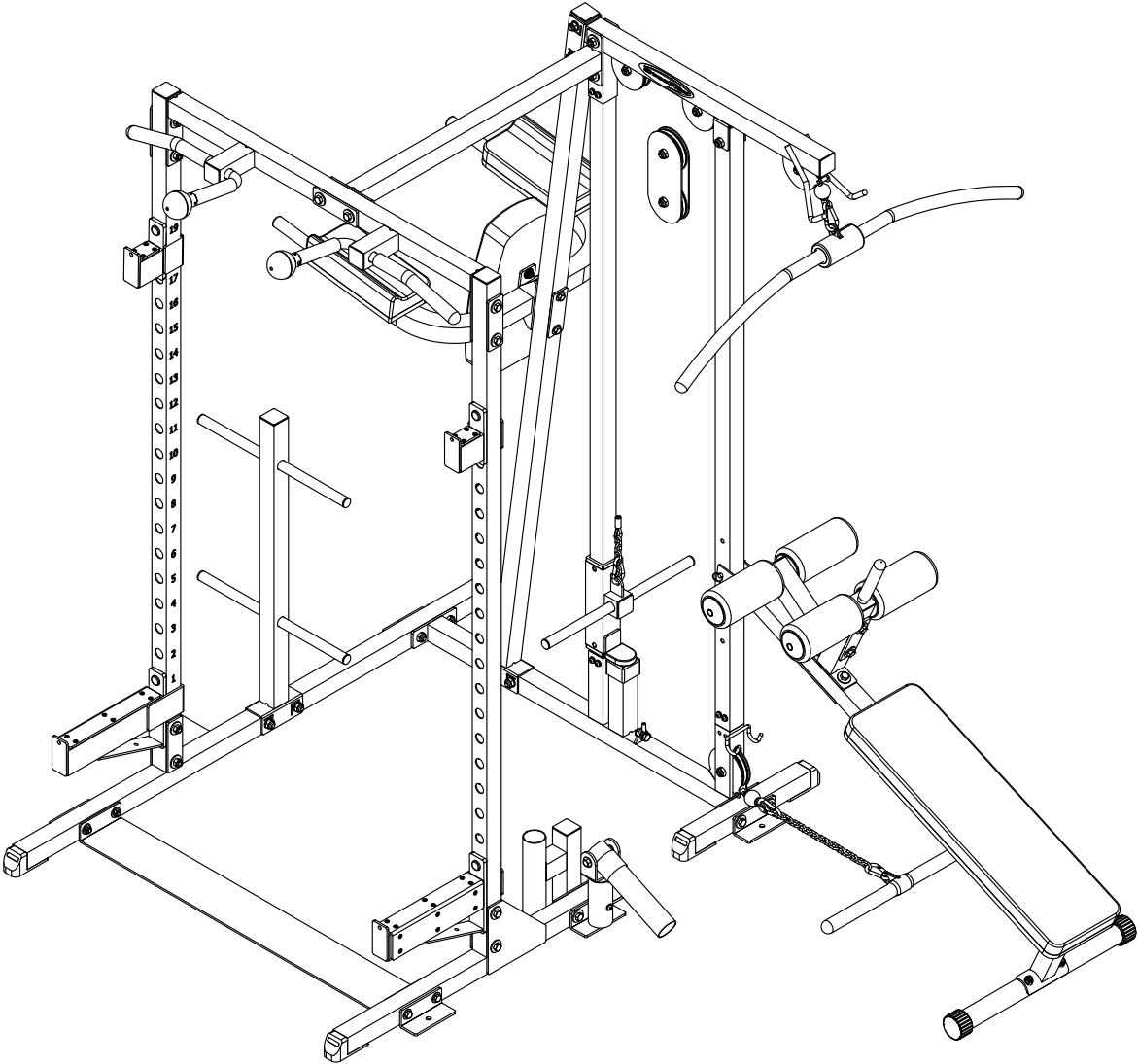

CLFWR



Assembly & Instructions
OWNER'S & MANUAL

CLFWR HARDWARE
(shown in actual size)

A1.M5X12L Cone Head Cross Screw Qty.32(Pre-installed)

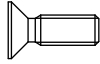

A2.M6X4L Countersunk Screw Qty.4(Pre-installed)



A3.M6X35L Half Round Head Hexagonal Screw Qty.2(Pre-installed)

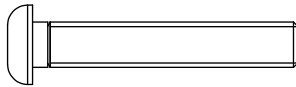

A4.M8X25L Half Round Head Hexagonal Screw Qty.5(1PCS Pre-installed)

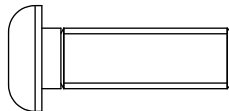
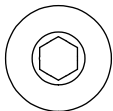

A5.M8X15L Half Round Head Hexagonal Screw Qty.12

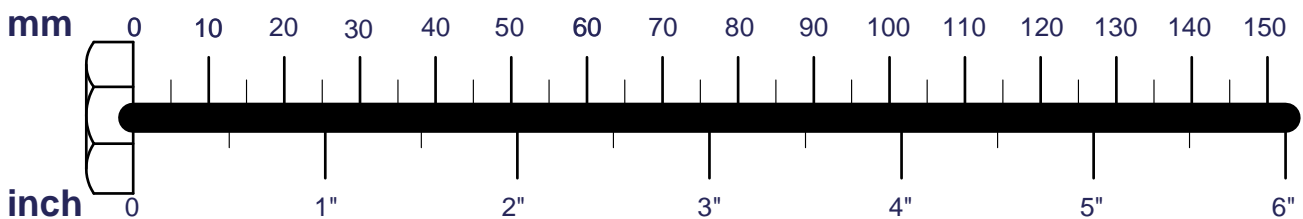
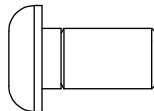
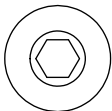

CLFWR HARDWARE
(shown in actual size)

A6.M10X45L Hex Head Bolt Qty.5

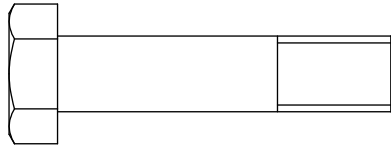
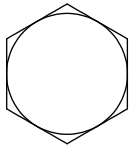

A7.M10X65L Hexagon Head Screw Qty.1

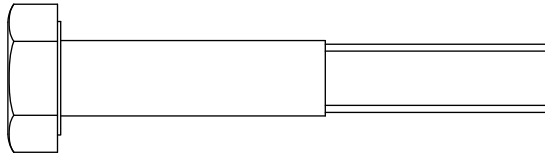
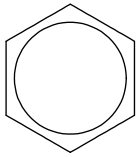

A8.M10X75L General Hexagonal Head Screw Qty.7

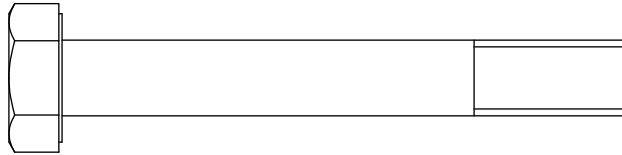
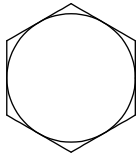

A9.M10X100L Hexagon Head Screw Qty.1

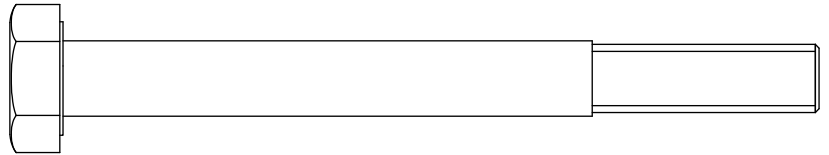
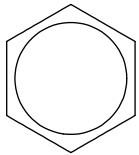

A10.M12X30L Ordinary Hexagonal Head Screw Qty.1

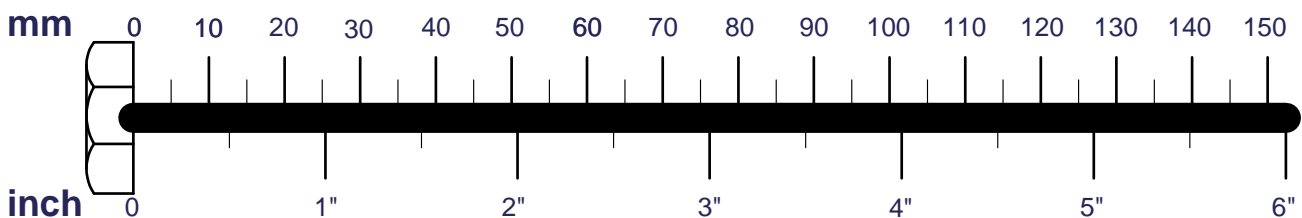
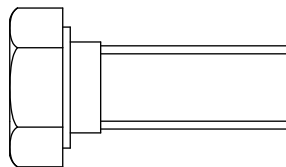
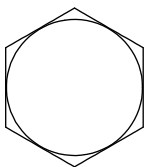

CLFWR HARDWARE
(shown in actual size)

A11.M12X75L General Hexagon Head Screw Qty.6

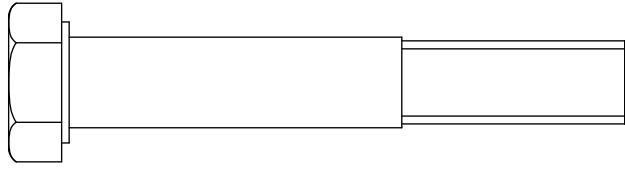
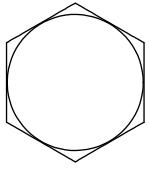

A12.M12X80L Ordinary Hexagonal Head Screw Qty.22

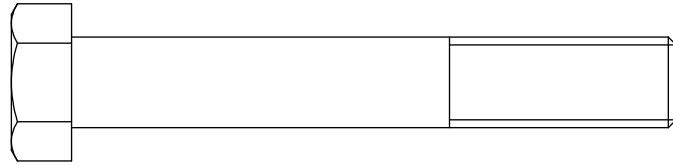
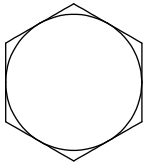

A13.M8X25L General Hexagon Head Screw Qty.2

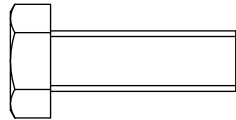
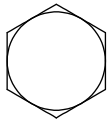

A14.M8X70L General Hexagon Head Screw Qty.4

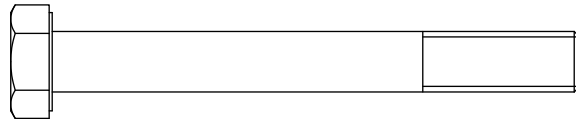
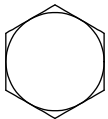

A15.M8X30L Half Round Head Hexagonal Screw Qty.4

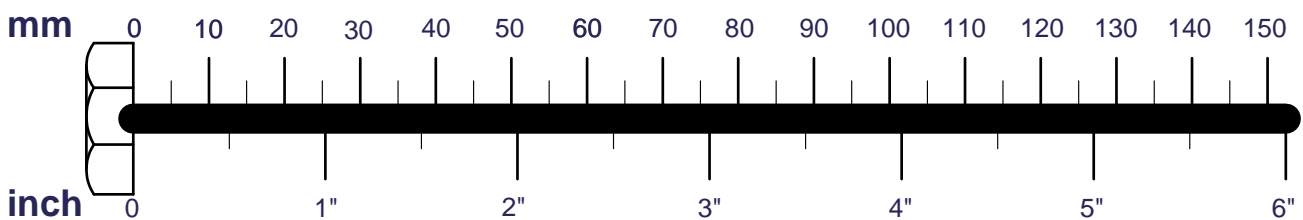
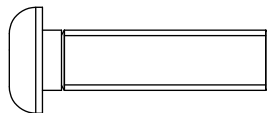
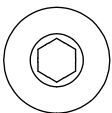

CLFWR HARDWARE
(shown in actual size)

A16.M10X70L Carriage Bolt Qty.2

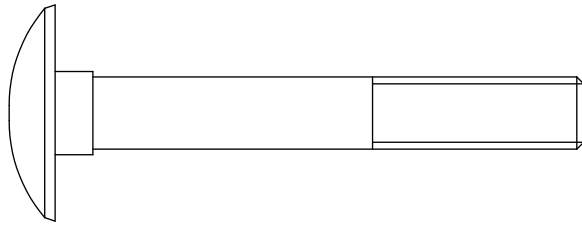
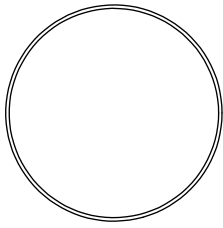

A17.14 Eye Chain(8820-011) Qty.1

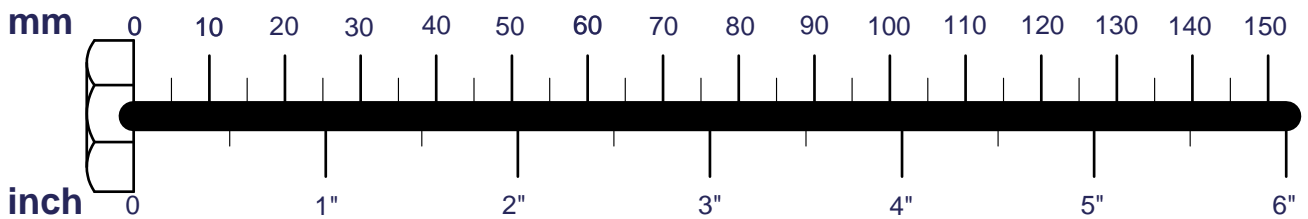
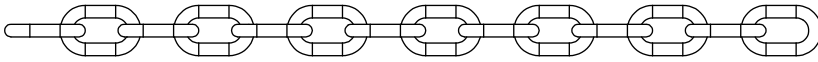

CLFWR HARDWARE
(shown in actual size)

B1.M10 Nylon Lock Nut Qty.16



B2.M12 Nylon Lock Nut Qty.29



C1.M8 Curved Washer Qty.1(Pre-installed)

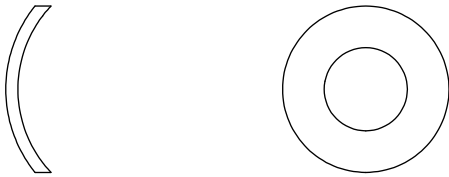

C2.M8 Spring Washer Qty.22



C3.M8-Ø16 Washer Qty.12



C4.M10-Ø27 Washer Qty.28

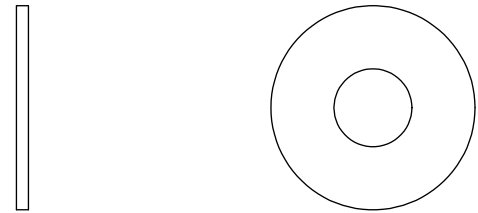

C5.M12-Ø20 Washer Qty.2

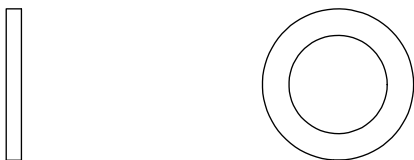

C6.M12-Ø34 Washer Qty.44

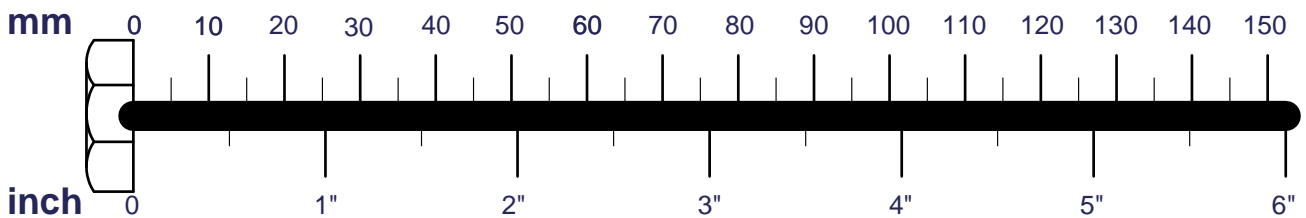
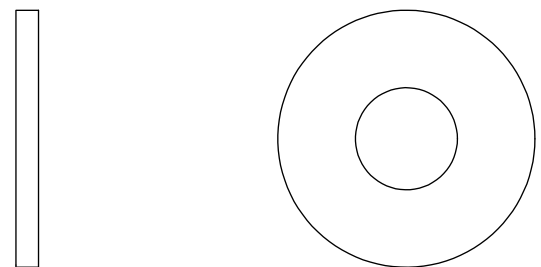

CLFWR HARDWARE
(shown in actual size)

C7.M12-Ø24 Washer Qty.12

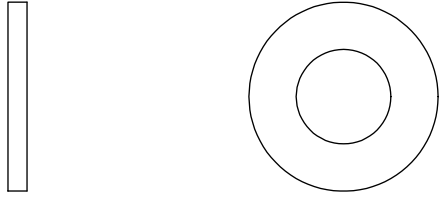

C8.M8-Ø24 Washer Qty.10

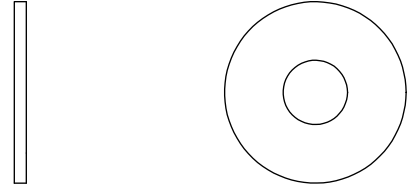

C9.M10 Curved Washer Qty.2

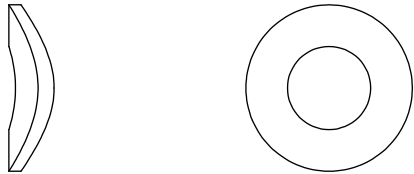

C10.M8-Ø14 Washer Qty.2

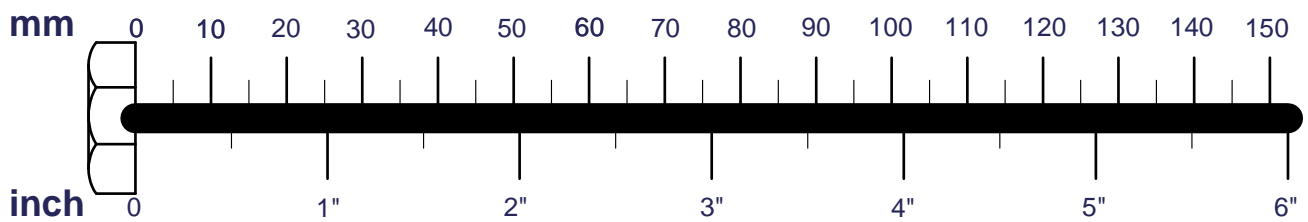

CLFWR HARDWARE
(shown in actual size)

A[1PCS]

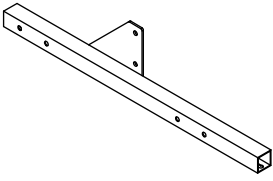

B[1PCS]

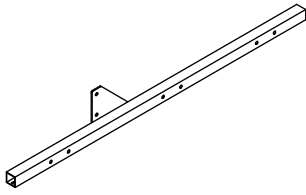

C[1PCS]

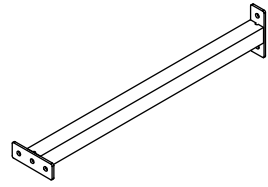

D[1PCS]

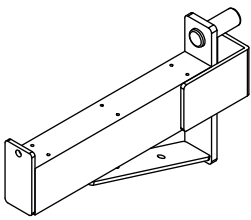

E[1PCS]

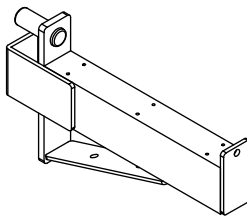

F[1PCS]

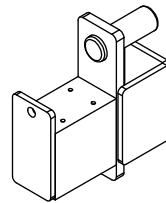

G[1PCS]

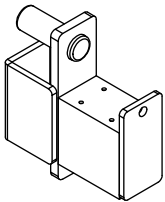

H[1PCS]

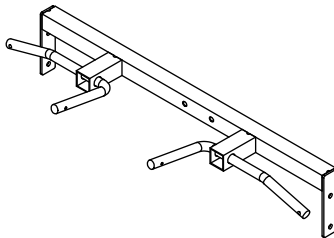

I[1PCS]

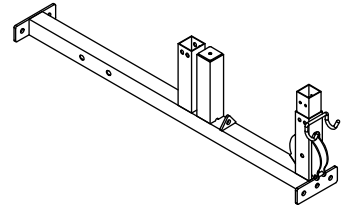

J[1PCS]

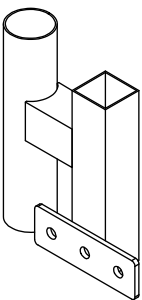

K[1PCS]

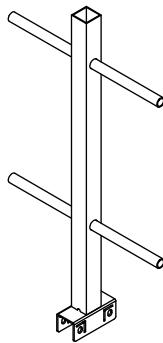

L[1PCS]

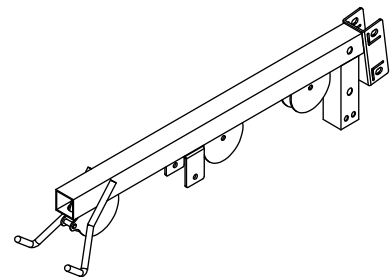

CLFWR HARDWARE
(shown in actual size)

M[1PCS]

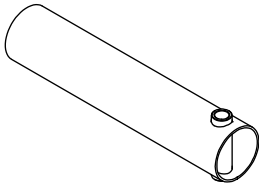

N[1PCS]

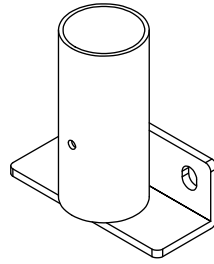

O[1PCS]

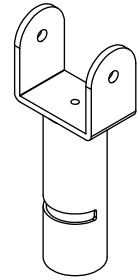

P[1PCS]

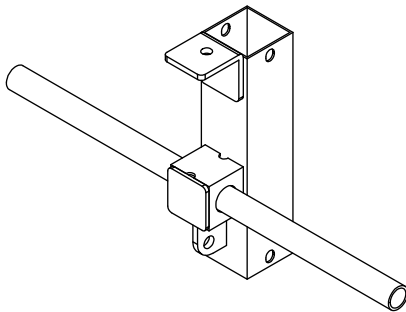

Q[1PCS]

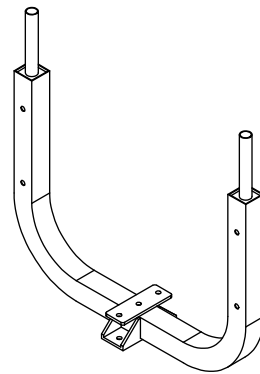

R[2PCS]

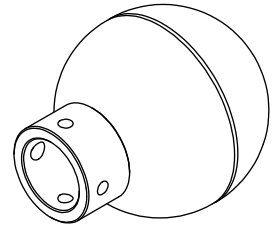

S[1PCS]

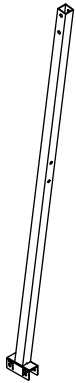

T[1PCS]

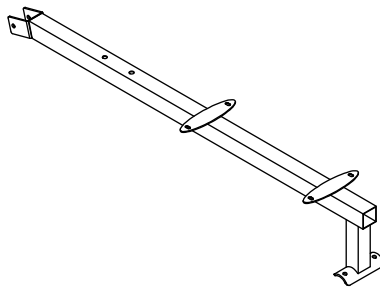

U[1PCS]

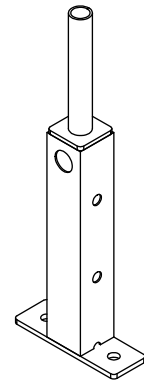

V[2PCS]

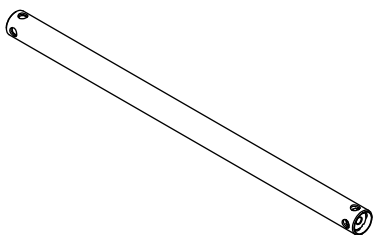

W[1PCS]

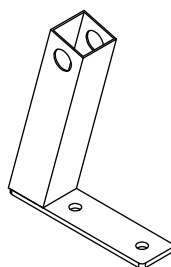

X[1PCS]
(20LB500C)

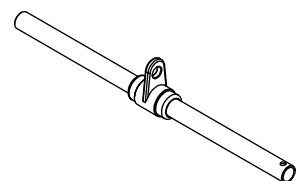

CLFWR HARDWARE
(shown in actual size)

Y[1PCS]
(20LB1200D)

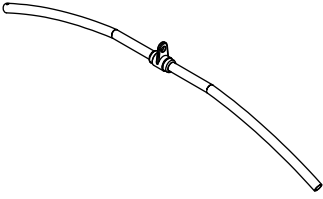

Z[8PCS]
(8312-062)

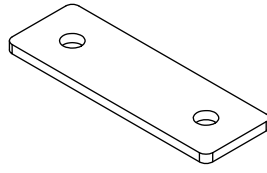

Z1[2PCS]
(8343-024)

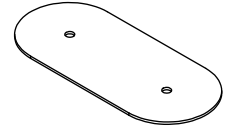

Z2[4PCS]
(8333-170)

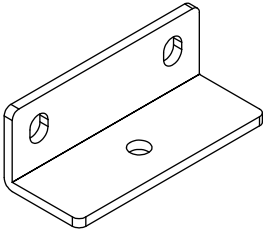

Z3[1PCS]
(8370-069)

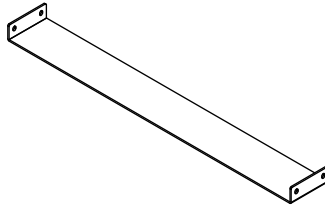

Z4[1PCS]
(9111-098)

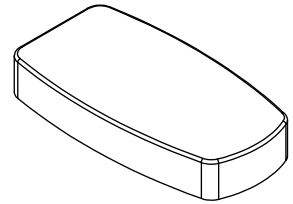

Z5[1PCS]
(8312-090)

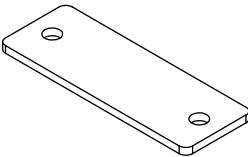

Z6[2PCS]
(9131-083)

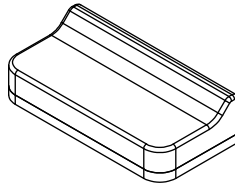

Z7[1PCS]
(9111-119)

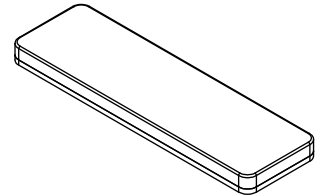

Z8[4PCS]
(9161-077)

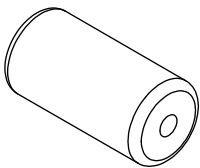

Z9[2PCS]
(10CLFWR-03)

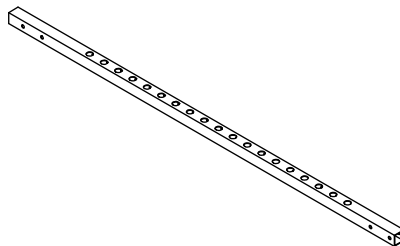

Z10[1PCS]
(10CLFWR-17)

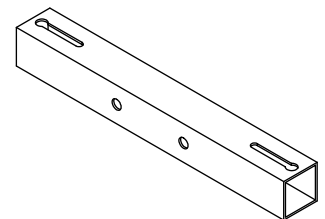

CLFWR HARDWARE
(shown in actual size)

Z11[1PCS]
(10CLFWR-19)

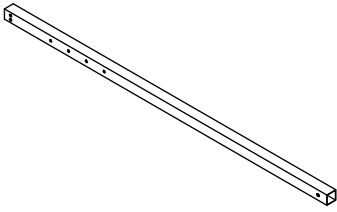

Z12[1PCS]
(10CLFWR-22)

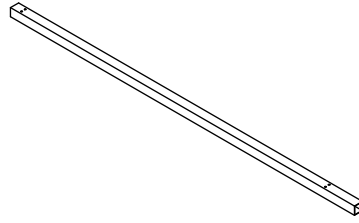

Z13[1PCS]
(10CLFWR-38)

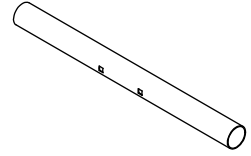

CLFWR HARDWARE
(shown in actual size)

D1.Squar Plug(9211-006).....	[8PCS]
D2.Round Plug(9211-016)(2PCSPre-installed).....	[8PCS]
D3.Hulu Hook(8810-001).....	[4PCS]
D4.Belt Pulley Assembly(9213-002C-01).....	[6PCS]
D5.Double Layered Cover(9211-032).....	[2PCS]
D6.Immersion Handle(9162-196)(Pre-installed).....	[2PCS]
D7.Horseshoe Plug(9211-081).....	[6PCS]
D8.Rubber Outer Sleeve(9310-020).....	[1PCS]
D9.Half Moon Shaped Blocking Plate(9310-019).....	[1PCS]
D10.Immersion Handle(9162-254)(Pre-installed).....	[2PCS]
D11.Medium Circular Pipe Sleeve(9211-040)(Pre-installed).....	[2PCS]
D12.Nylon Huasi(9214-008).....	[4PCS]
D13.Shaft End Cover(9211-157).....	[4PCS]
D14.Immersion Handle(9162-047)(Pre-installed).....	[1PCS]
D15.Immersion Handle(9162-174)(Pre-installed).....	[2PCS]
D16.Squar Plug(9211-005).....	[2PCS]
D17.Double Bead Pin(8250-039).....	[1PCS]
D18.Outer Tube Plug(9212-008).....	[2PCS]
D19.Immersion Handle(9162-194)(Pre-installed).....	[2PCS]
D20.Immersion Handle(9162-131)(Pre-installed).....	[2PCS]
D21.Immersion Handle(9162-184)(Pre-installed).....	[1PCS]
D22.Bronze Bushing(8520-011)(Pre-installed).....	[2PCS]
D23.Foam(9161-003)(Pre-installed).....	[1PCS]
D24.Foam(9161-002)(Pre-installed).....	[2PCS]
D25.Rubber Pad(9310-142)(Pre-installed).....	[2PCS]
D26.Rubber Pad(9310-143)(Pre-installed).....	[2PCS]
D27.Steel Cable 2620mm.....	[1PCS]
D28.Steel Cable 3590mm.....	[1PCS]

D1

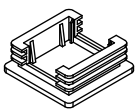

D2



D3



D4



D5

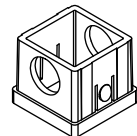

D6

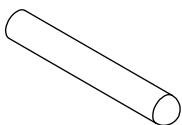

D7

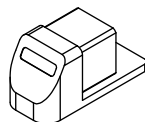

D8

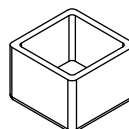

D9

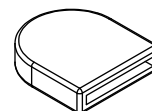

D10

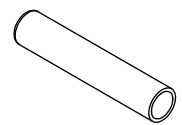

D11

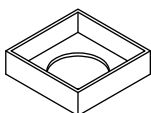

D12

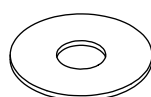

D13

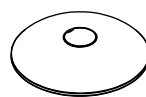

D14

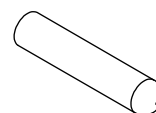

D15

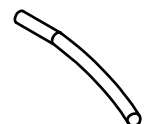

CLFWR HARDWARE
(shown in actual size)

D16

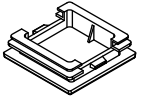

D17

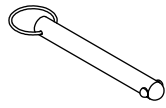

D18

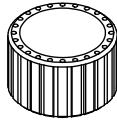

D19

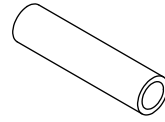

D20

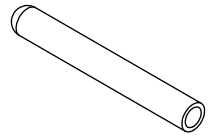

D21

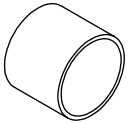

D22

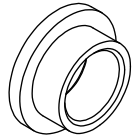

D23

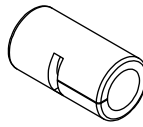

D24

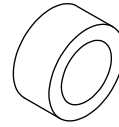

D25

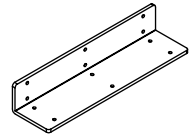

D26

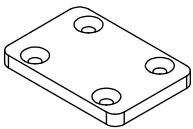

D27

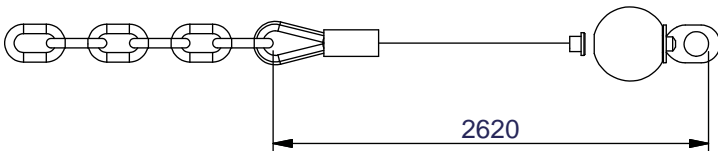

D28

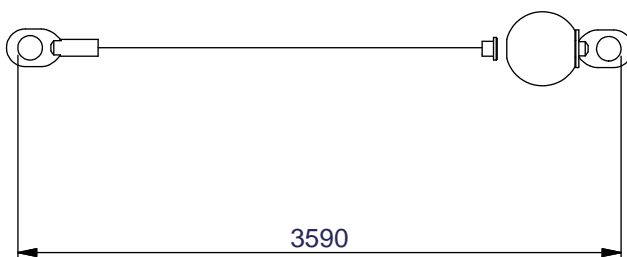

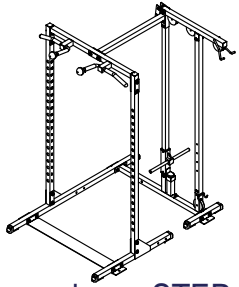

Above shows STEP 1 assembled and completed

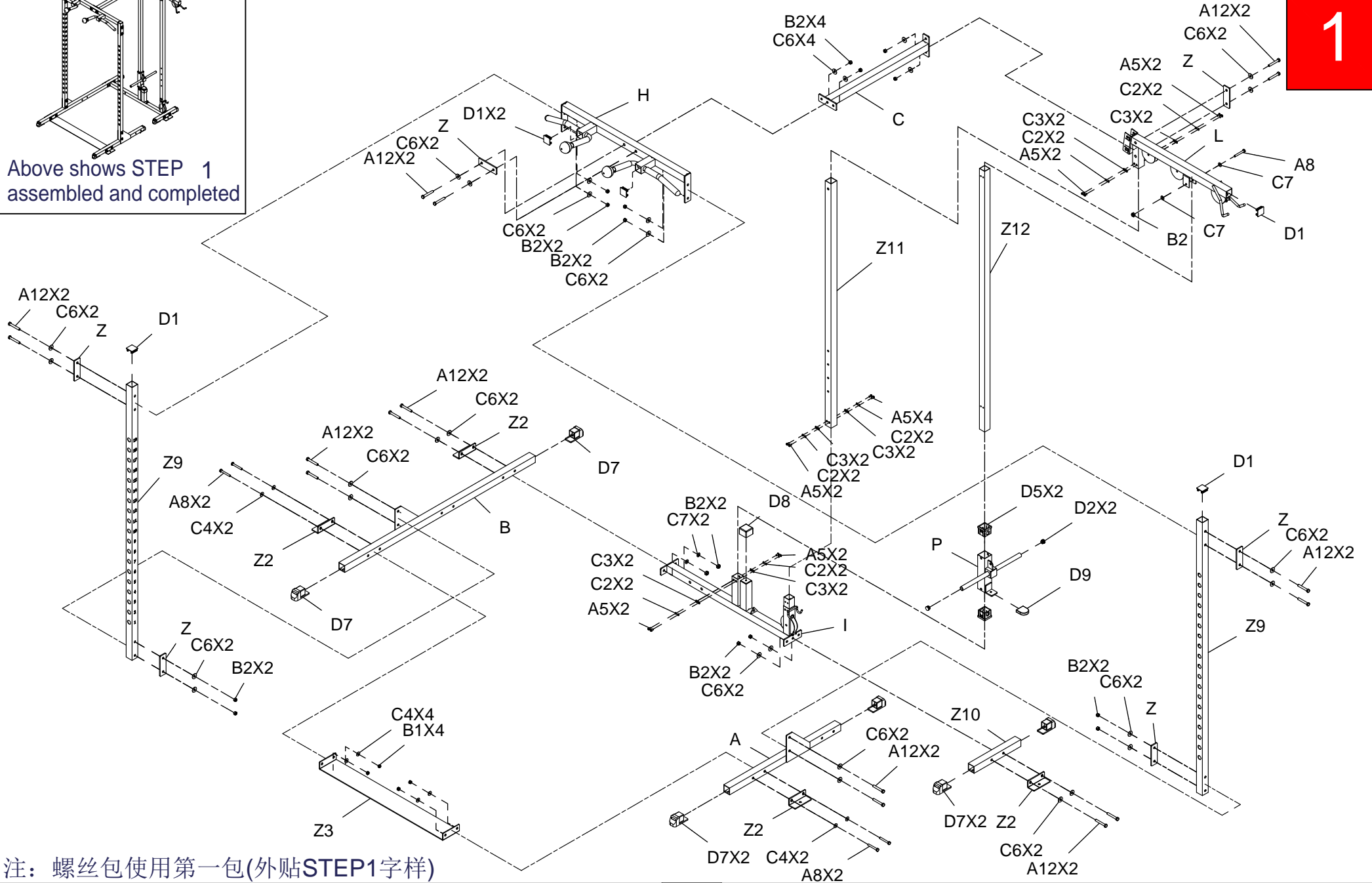

注：螺丝包使用第一包(外贴STEP1字样)

注：螺丝包使用第一包(外贴STEP1字样)

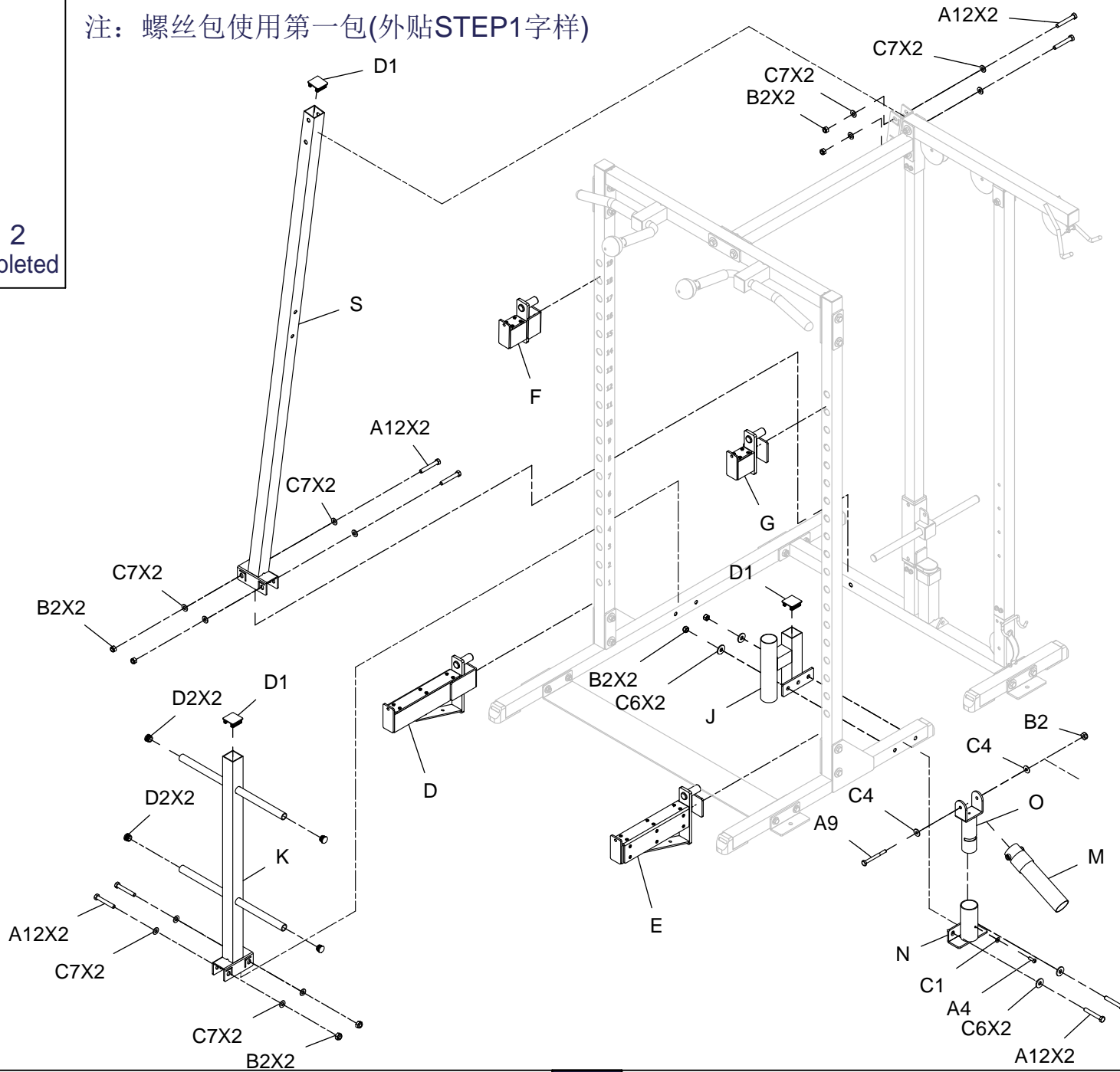

STEP
4

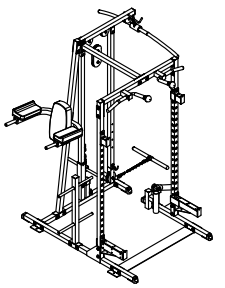

Above shows STEP 4 assembled and completed

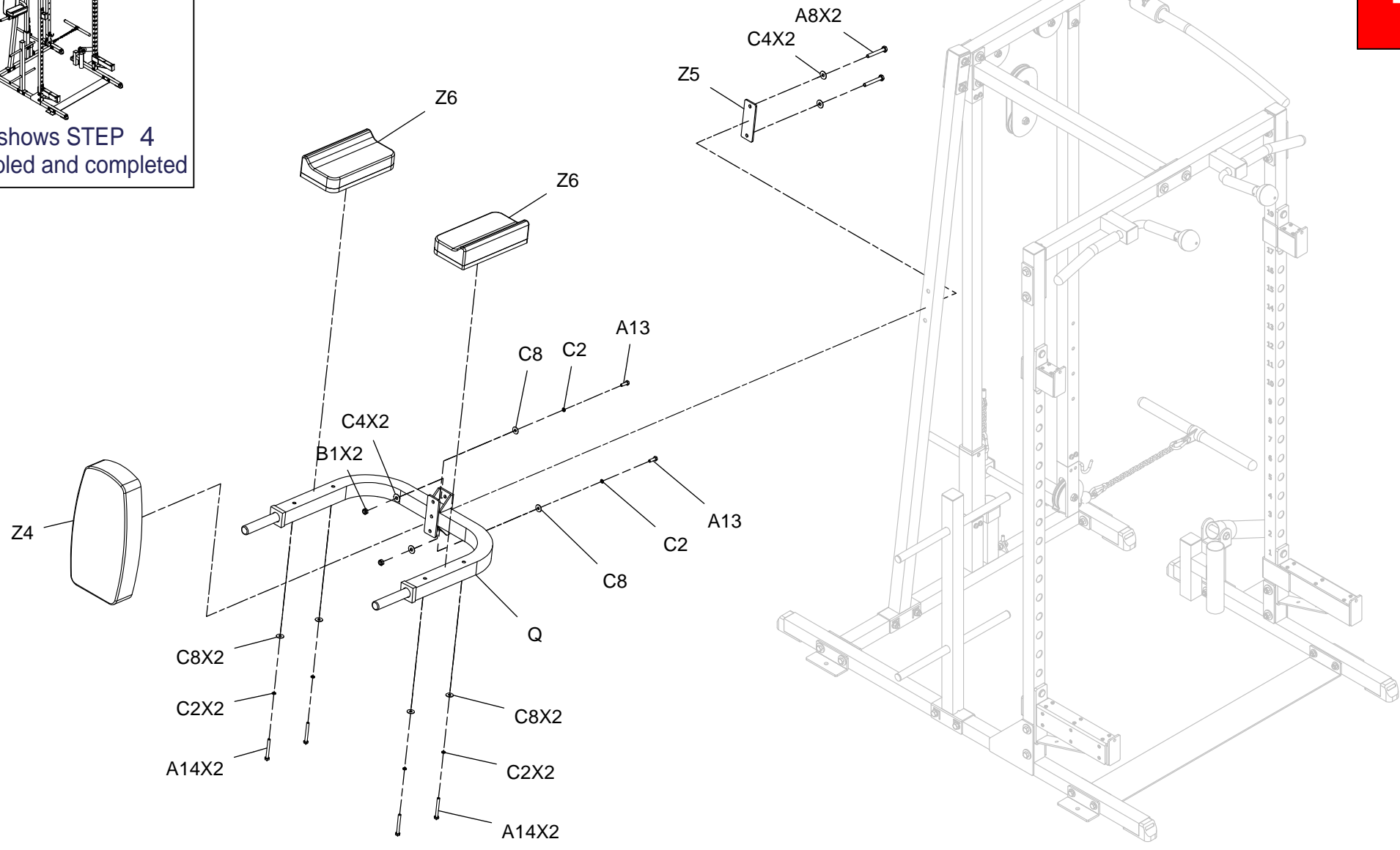

注：螺丝包使用第二包(外贴STEP2字样)

CLFWR Exploded View

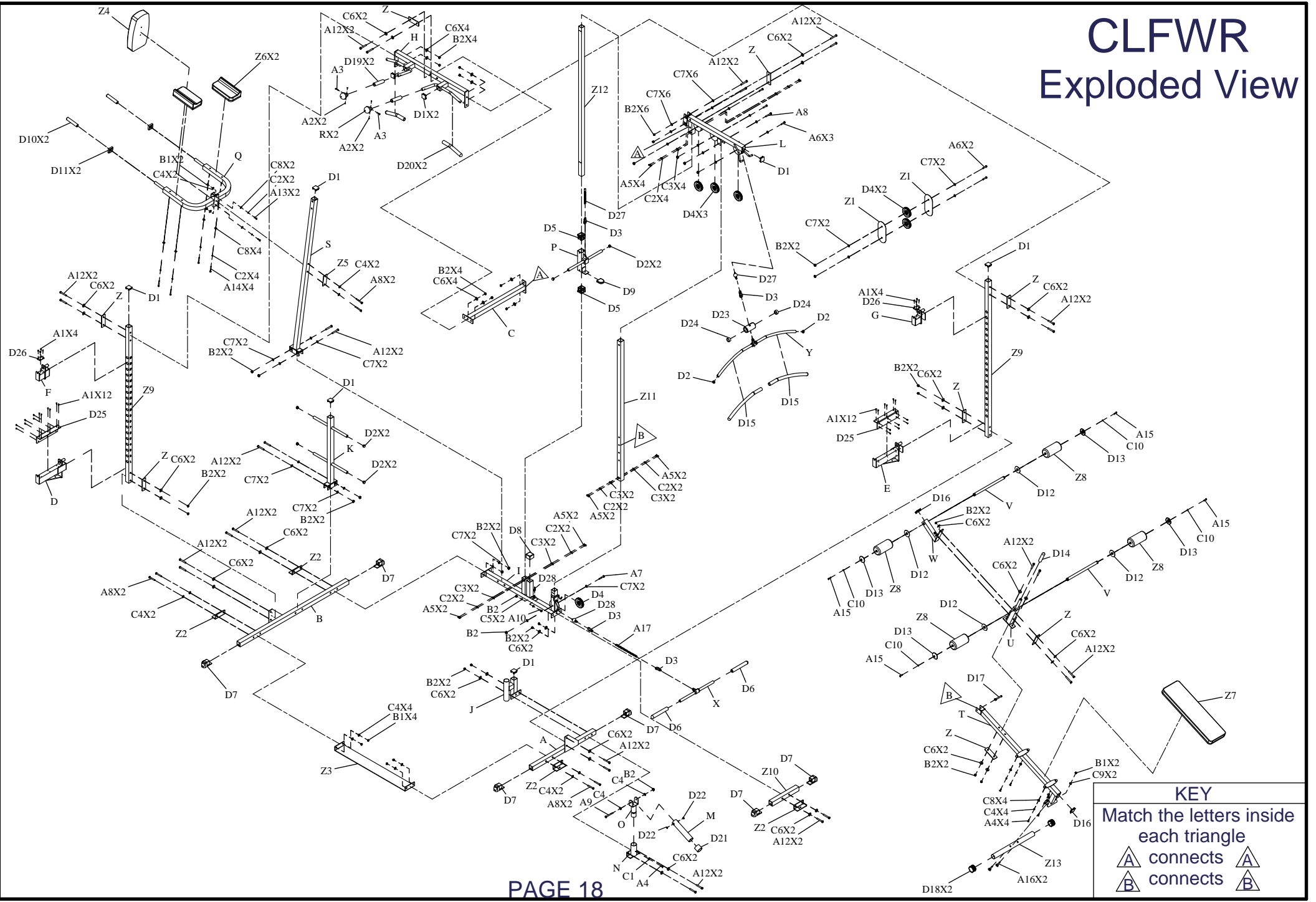

KEY
Match the letters inside each triangle

	connects	
	connects	

CLFWR 钢索示意图

