

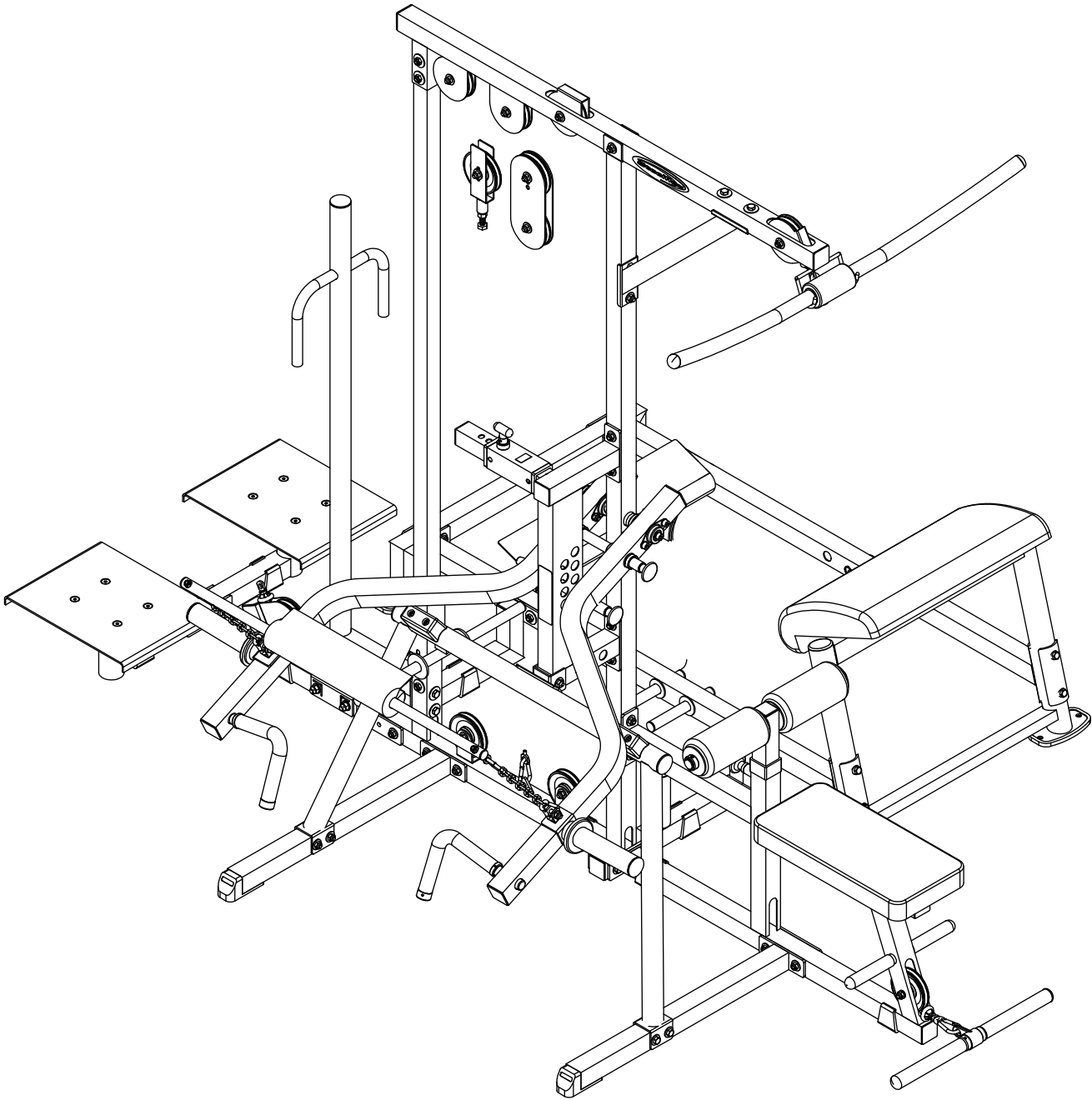

*CLPM3*



Assembly & Instructions  
**OWNER'S & MANUAL**

**CLPM3 HARDWARE**  
(shown in actual size)

A1.5/16"X5/16"L Countersunk Hexagon Socket Screw Qty.2(Pre-installed)



A2.M5X4L Countersunk Hexagon Socket Screw Qty.12(Pre-installed)



A3.M5X10L Conical Flat Head Cross Screw Qty.6(Pre-installed)



A4.M8X8L Countersunk Hexagon Socket Screw Qty.2(Pre-installed)



A5.M10X20L-CAP Round Head Hexagon Socket Screw Qty.2(Pre-installed)

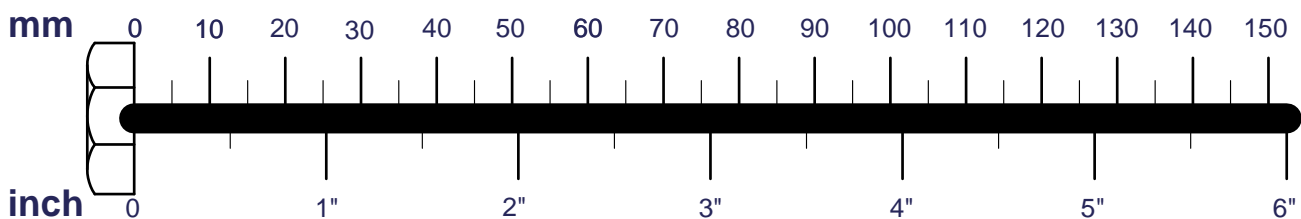

**CLPM3 HARDWARE**  
(shown in actual size)

A6.M10X70L-CAP Round Head Hexagon Socket Screw Qty.4(Pre-installed)

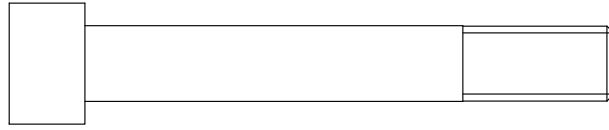
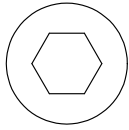

A7.M8X25L General Hexagonal Head Screws Qty.4

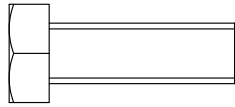
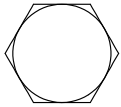

A8.M8X70L General Hexagonal Head Screws Qty.2

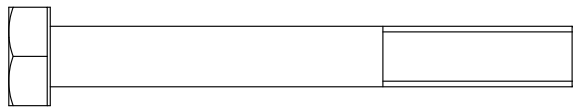
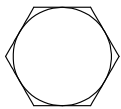

A9.M10X45L General Hexagonal Head Screws Qty.8

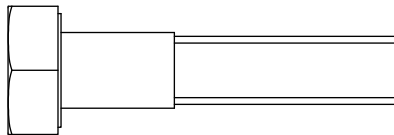
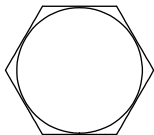

A10.M10X65L General Hexagonal Head Screws Qty.8

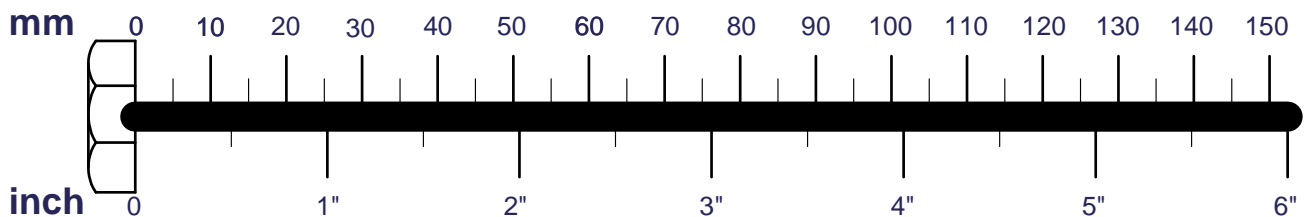
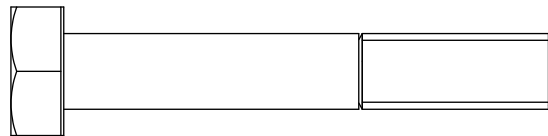
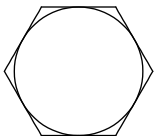

**CLPM3 HARDWARE**  
(shown in actual size)

A11.M10X70L General Hexagonal Head Screws Qty.15

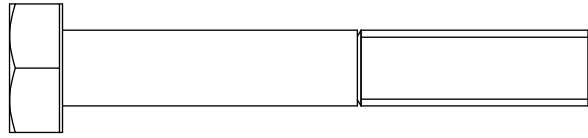
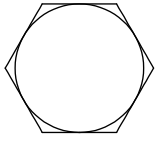

A12.M10X75L General Hexagonal Head Screws Qty.18

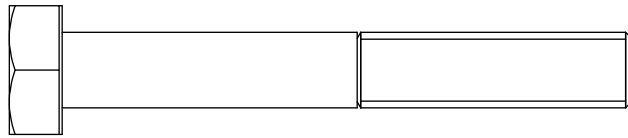
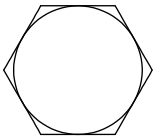

A13.M10X85L General Hexagonal Head Screws Qty.6

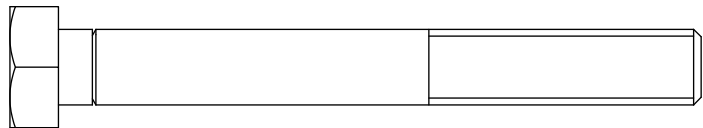
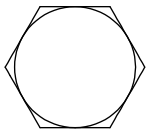

A14.M10X25L Conical Flat Head Hexagon Socket Screw Qty.8

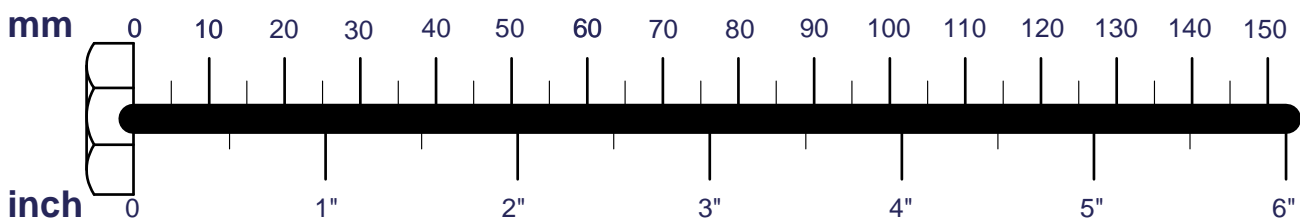
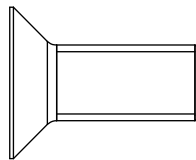
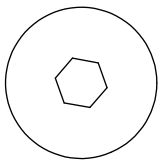

**CLPM3 HARDWARE**  
(shown in actual size)

A15.M10X40L-CAP Round Head Hexagon Socket Screw Qty.2

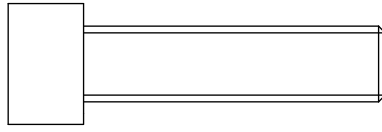
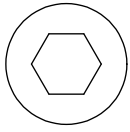

A16.M10X95L-CAP Round Head Hexagon Socket Screw Qty.4

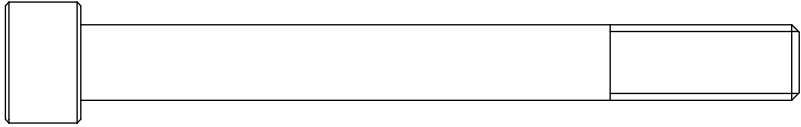
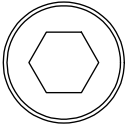

A17.M12X25L General Hexagonal Head Screws Qty.1

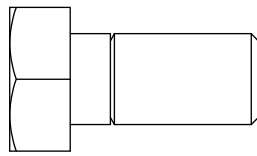
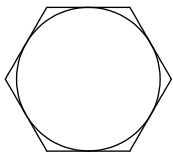

A18.M12X80L General Hexagonal Head Screws Qty.2

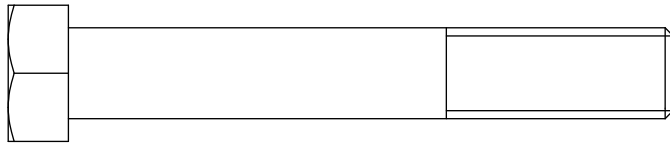
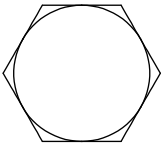

A19.Fixed Hook (8292-149) Qty.2

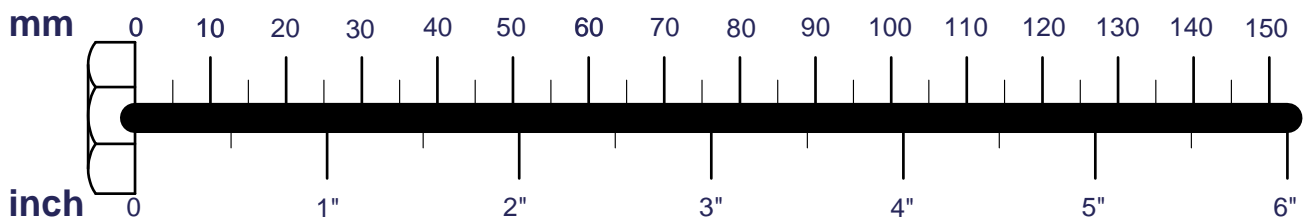
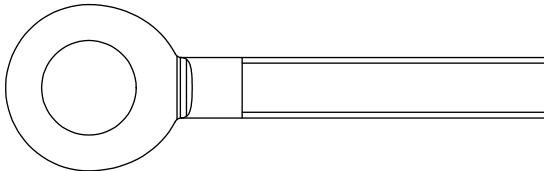

**CLPM3 HARDWARE**  
(shown in actual size)

B1.M8 NYLON LOCK NUT Qty.2



B2.M10 NYLON LOCK NUT Qty.68(4PCS Pre-installed)



B3.M12 NYLON LOCK NUT Qty.3

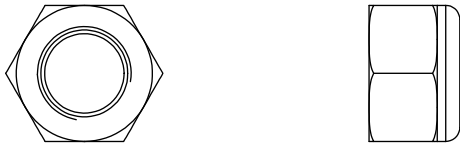

B4.M8 NUT Qty.2



B5.1/2"-13 NUT Qty.1

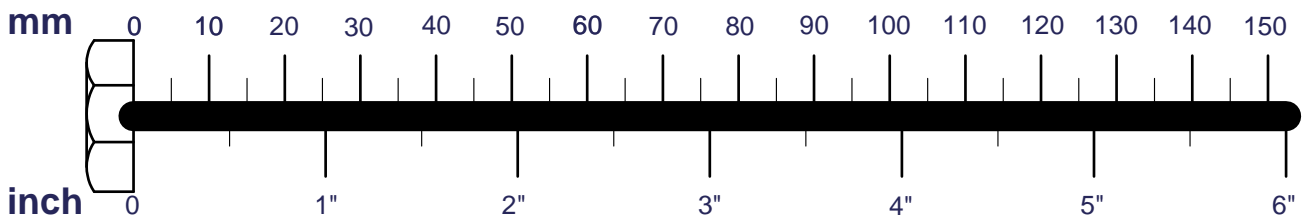

**CLPM3 HARDWARE**  
(shown in actual size)

C1.M8 SPRING WASHER Qty.6



C2.M10 SPRING WASHER Qty.2(Pre-installed)

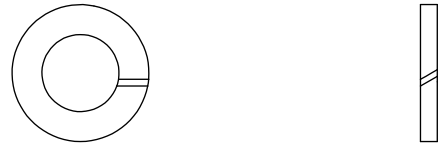

C3.M8 CURVED WASHER Qty.4

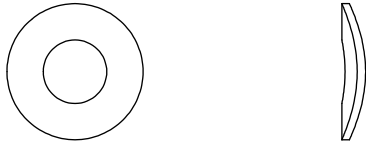

C4.M10 CURVED WASHER Qty.12

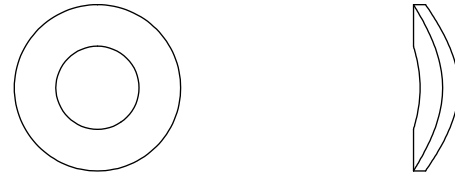

C5.1/2" SPRING WASHER Qty.1

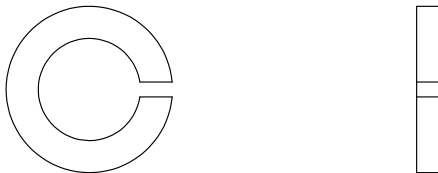

C6.10 MESH CHAIN(8820-009) Qty.2

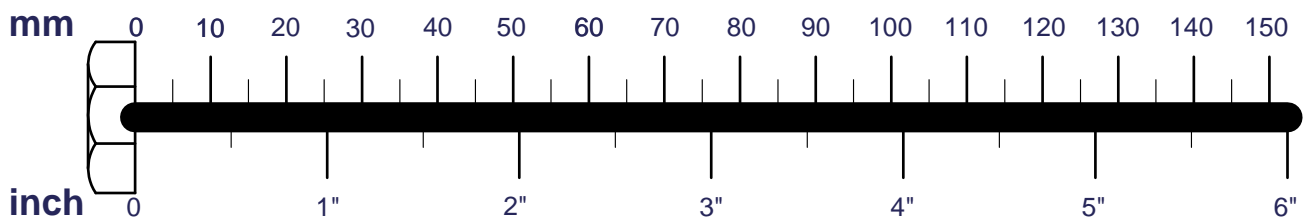
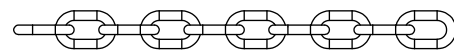

**CLPM3 HARDWARE**  
(shown in actual size)

C7.M8 WASHER-(Ø24) Qty.6

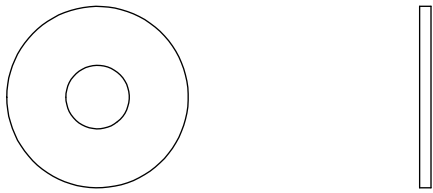

C8.M10 WASHER-(Ø19) Qty.14(8 Pre-installed)

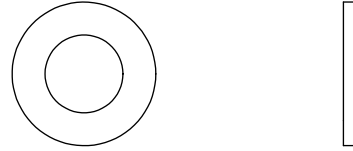

C9.M10 WASHER-(Ø27) Qty.79

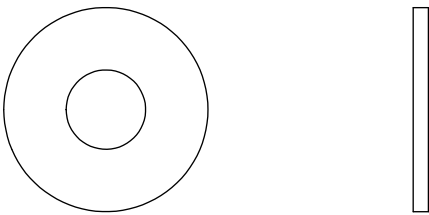

C10.M10 WASHER-(Ø35) Qty.24

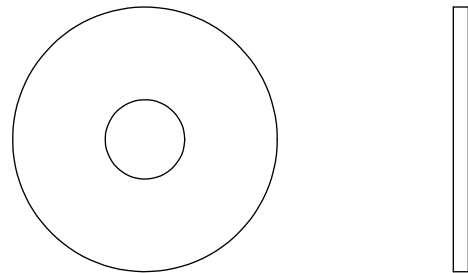

C11.M12 WASHER-(Ø25) Qty.6

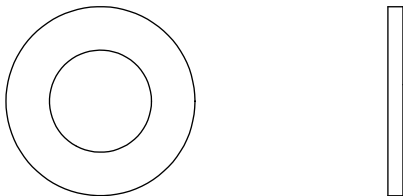

C12.M10 WASHER-(Ø25) Qty.4(2 Pre-installed)

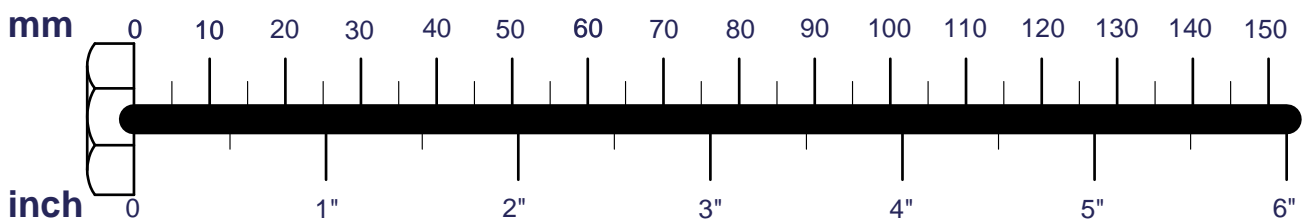
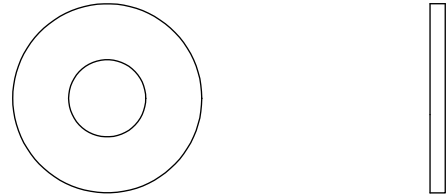

CLPM3 HARDWARE  
(shown in actual size)

A[1PCS]

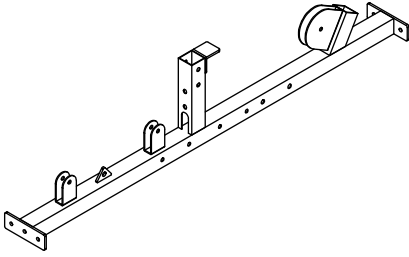

B[1PCS]

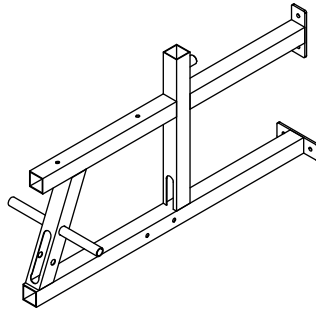

C[1PCS]

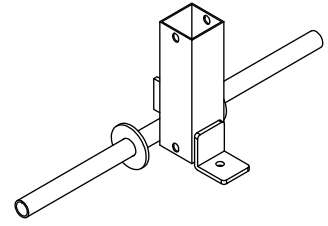

D[1PCS]

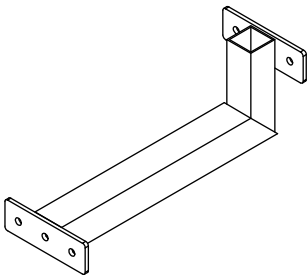

E[1PCS]

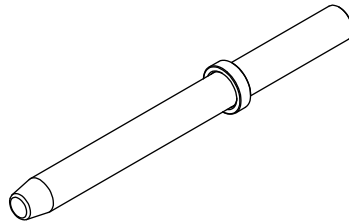

F[1PCS]

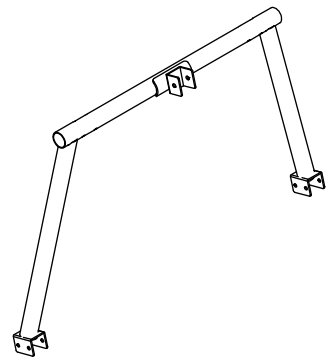

G[1PCS]

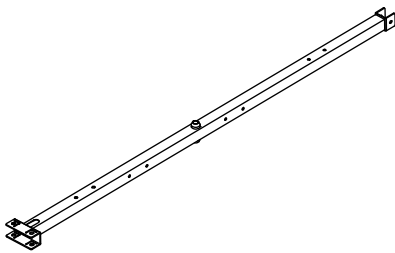

H[1PCS]

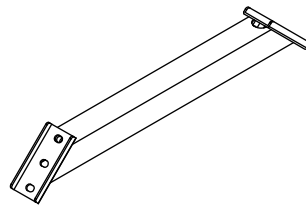

I[1PCS]

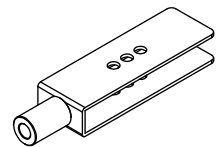

J[1PCS]

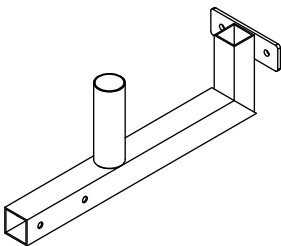

K[1PCS]

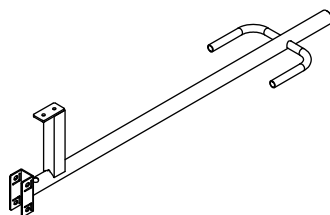

L[1PCS]

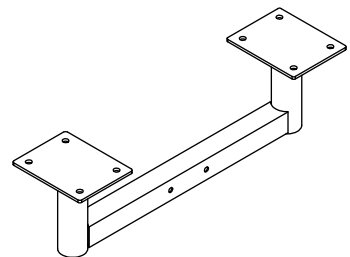

CLPM3 HARDWARE  
(shown in actual size)

M[1PCS]

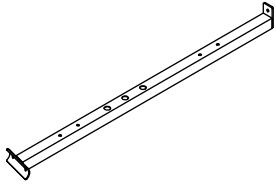

N[1PCS]

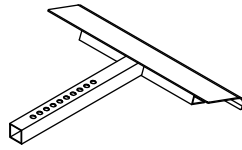

O[1PCS]

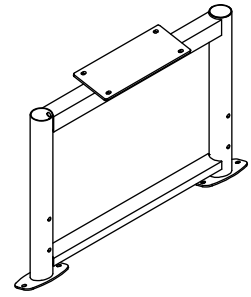

P[1PCS]

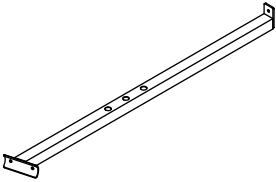

Q[4PCS]

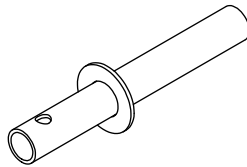

R[1PCS]

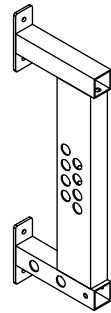

S[1PCS]

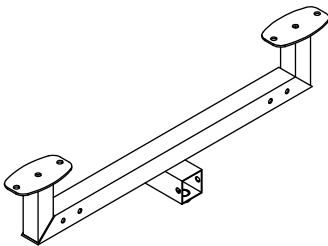

T[2PCS]

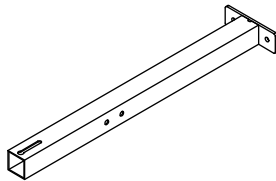

U[1PCS]

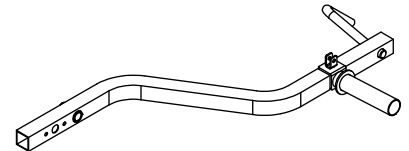

V[1PCS]

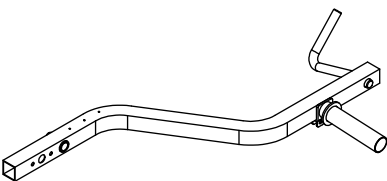

W[1PCS]

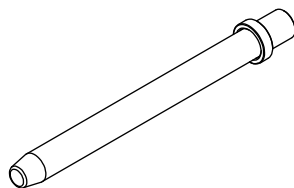

X[1PCS]

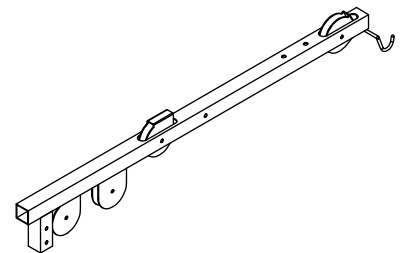

**CLPM3 HARDWARE**  
(shown in actual size)

AA[1PCS]  
(10CLPM3-21)

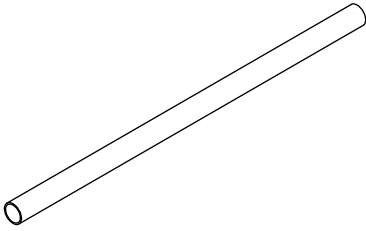

AB[1PCS]  
(8220-350)

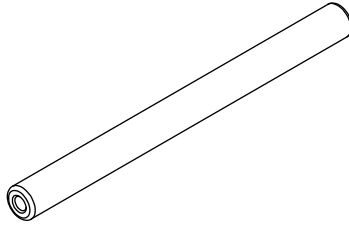

AC[1PCS]  
(10CLPM3-14)

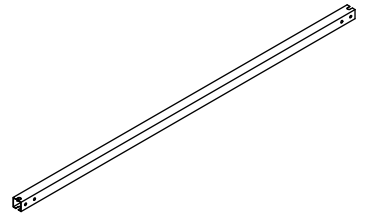

AD[1PCS]  
(20LB500E)

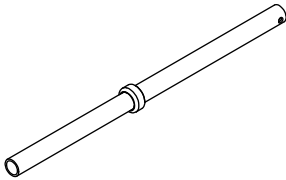

AE[1PCS]  
(20LB1200J)

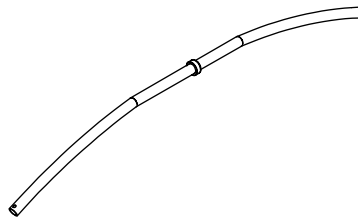

AF[4PCS]  
(8312-060)

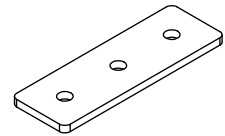

AG[2PCS]  
(8343-421)

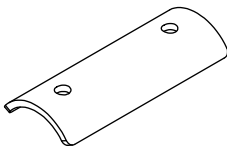

AH[2PCS]  
(8343-070)

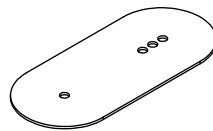

AI[2PCS]  
(8312-049)

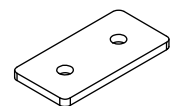

AJ[2PCS]  
(9161-018)

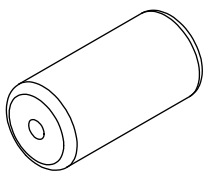

AK[1PCS]  
(10CLPM3-20)

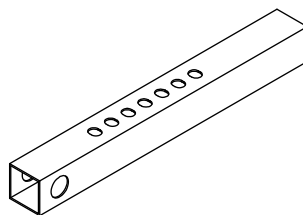

AL[1PCS]  
(9252-049)

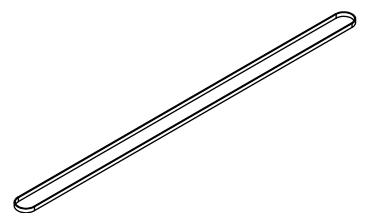

**CLPM3 HARDWARE**  
(shown in actual size)

AM[1PCS]  
(9252-050)

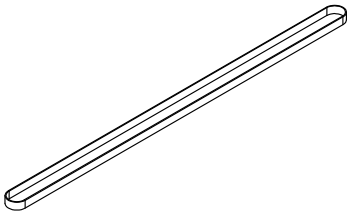

AN[1PCS]  
(MA-105)

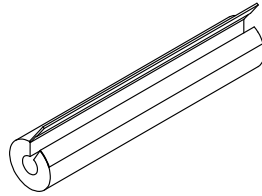

AO[1PCS]  
(9630-311)

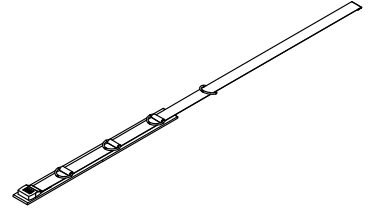

AP[2PCS]  
(8370-085)

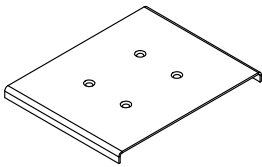

AQ[1PCS]  
(9131-076)

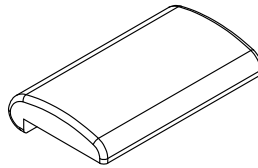

AR[1PCS]  
(9121-132)

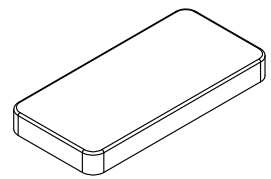

AS[1PCS]  
(10CLPM3-26)

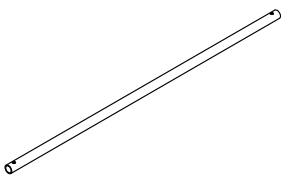

**CLPM3 HARDWARE**  
( shown in actual size )

D1.The Bundle(8130-024)(Pre-installed).....	[2PCS]
D2.Fixed Bundle(8130-254)(Pre-installed).....	[2PCS]
D3.Rotating Ring(8130-464)(Pre-installed).....	[2PCS]
D4.Iron Sleeve(8130-465)(Pre-installed).....	[2PCS]
D5.Double Ball Insert(8250-014).....	[4PCS]
D6.Car Repair Adjustment Group(8250-066G)(Pre-installed).....	[1PCS]
D7.Adjustment Group(8250-139)(Pre-installed).....	[1PCS]
D8.Foot Pads(9310-076).....	[4PCS]
D9.Fixed Bearing Plate(8341-031)(Pre-installed).....	[4PCS]
D10.Iron Sleeve(8530-009).....	[2PCS]
D11.The Bearing(8510-010)(Pre-installed).....	[4PCS]
D12.Gourd Hook(8810-001).....	[7PCS]
D13.Iron Sleeve(8890-061)(Pre-installed).....	[2PCS]
D14.The Foam(9161-002)(Pre-installed).....	[2PCS]
D15.The Foam(9161-003)(Pre-installed).....	[1PCS]
D16.Dip Handle(9162-047)(Pre-installed).....	[2PCS]
D17.Dip Handle(9162-182)(Pre-installed).....	[2PCS]
D18.Dip Handle(9162-246)(Pre-installed).....	[2PCS]
D19.Dip Handle(9162-247)(Pre-installed).....	[2PCS]
D20.Square Stopper(9211-004).....	[4PCS]
D21.Blocking Block(9310-078).....	[2PCS]
D22.Square Stopper(9211-006).....	[13PCS]
D23.The Shim(9310-128)(Pre-installed).....	[2PCS]
D24.Round Stopper(9211-020).....	[5PCS]
D25.Double Layer Cover(9211-030).....	[1PCS]
D26.Double Layer Cover(9211-032).....	[4PCS]
D27.Pipe Plug(9211-016)(2PCS Pre-installed).....	[16PCS]
D28.Horseshoe Plug(9211-081).....	[2PCS]
D29.Round End Plug(9211-101).....	[2PCS]
D30.Belt Pulley(9212-010).....	[8PCS]
D31.Spring Clip(9213-002C-01).....	[11PCS]
D32.Nylon Huasi(9214-008).....	[4PCS]
D33.Yellow Shiitake Mushroom Head(8250-176)(Pre-installed)....	[2PCS]
D34.The Mat(9220-059)(Pre-installed).....	[2PCS]
D35.Semicircular Plug(9260-021)(Pre-installed).....	[4PCS]
D36.Half moon shaped blocking plate(9310-019).....	[1PCS]
D37.The Steel Cable(FCLPM3A) 4110mm.....	[1PCS]
D38.The Steel Cable(FCLPM3B) 2325mm.....	[1PCS]
D39.The Steel Cable(FCLPM3C) 4715mm.....	[1PCS]
D40.Rubber Pad(9310-016).....	[2PCS]

**CLPM3 HARDWARE**  
(shown in actual size)

D1

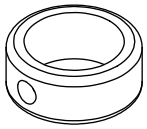

D2

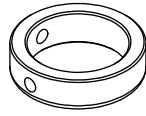

D3



D4



D5

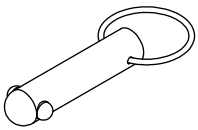

D6

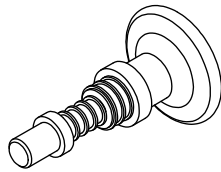

D7

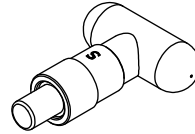

D8

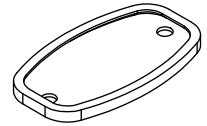

D9

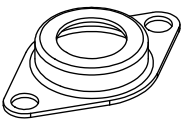

D10

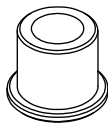

D11

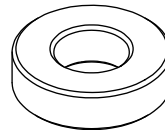

D12

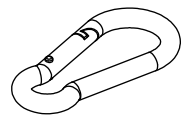

D13

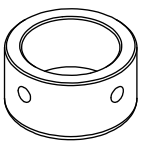

D14

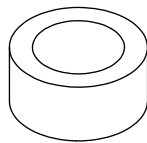

D15

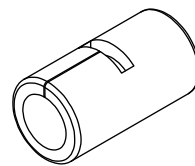

D16

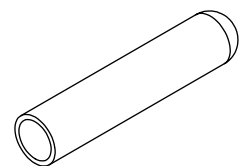

D17

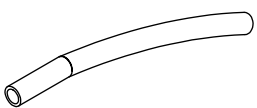

D18

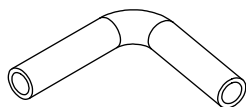

D19

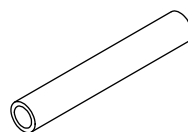

D20

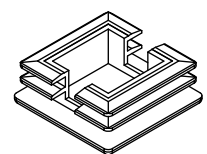

CLPM3 HARDWARE  
(shown in actual size)

D21

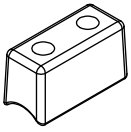

D22

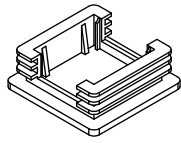

D23

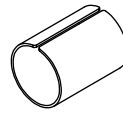

D24



D25

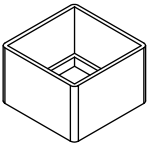

D26

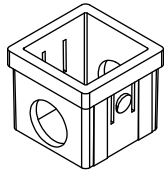

D27

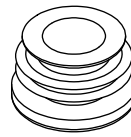

D28

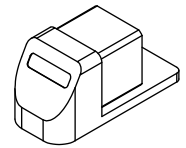

D29

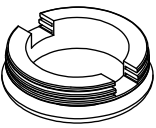

D30

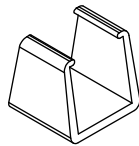

D31



D32

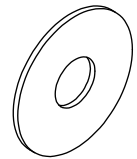

D33



D34

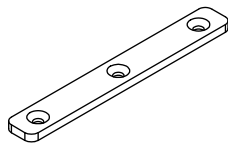

D35

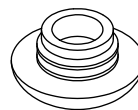

D36

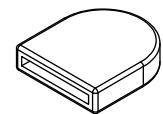

D40

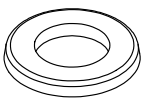

**CLPM3 HARDWARE**  
(shown in actual size)

D37

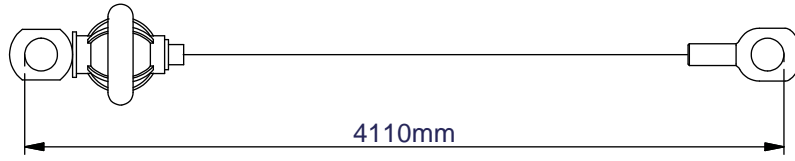

D38

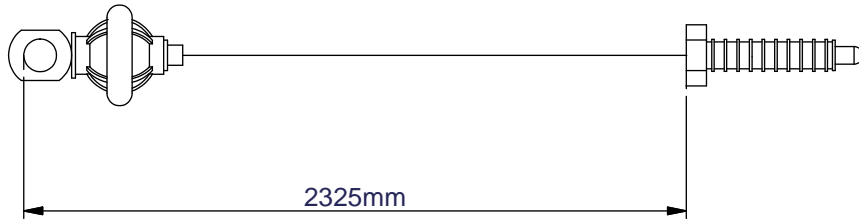

D39

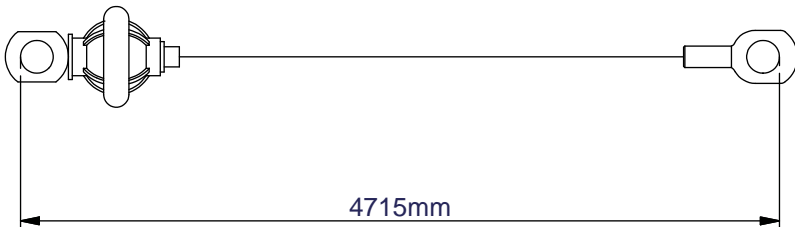

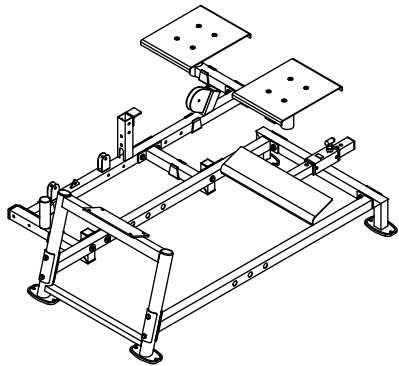

Above shows STEP 1 assembled and completed

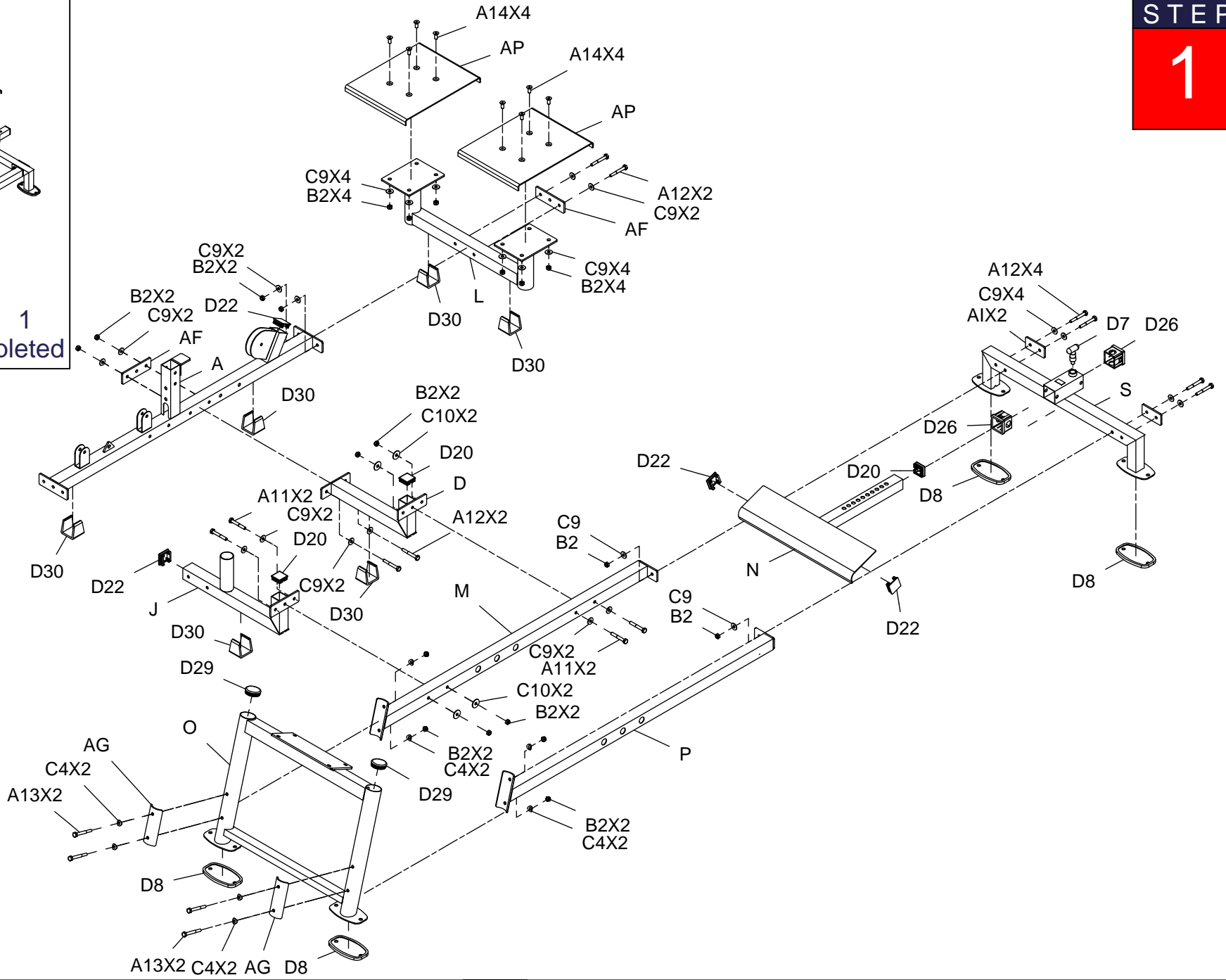

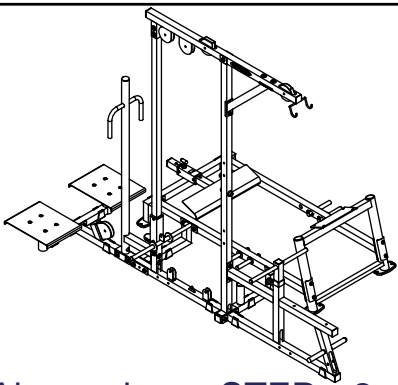

Above shows STEP 2 assembled and completed

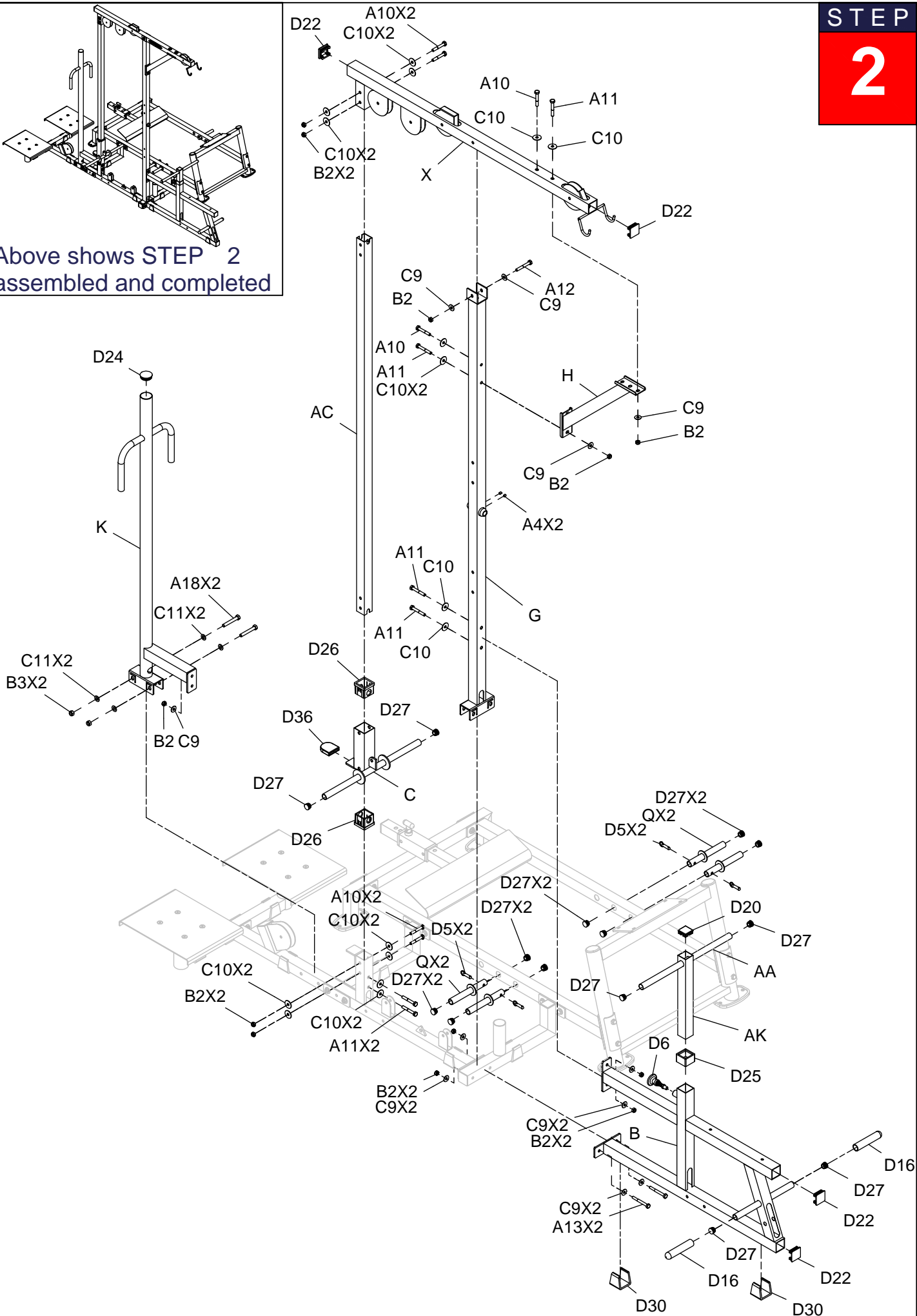



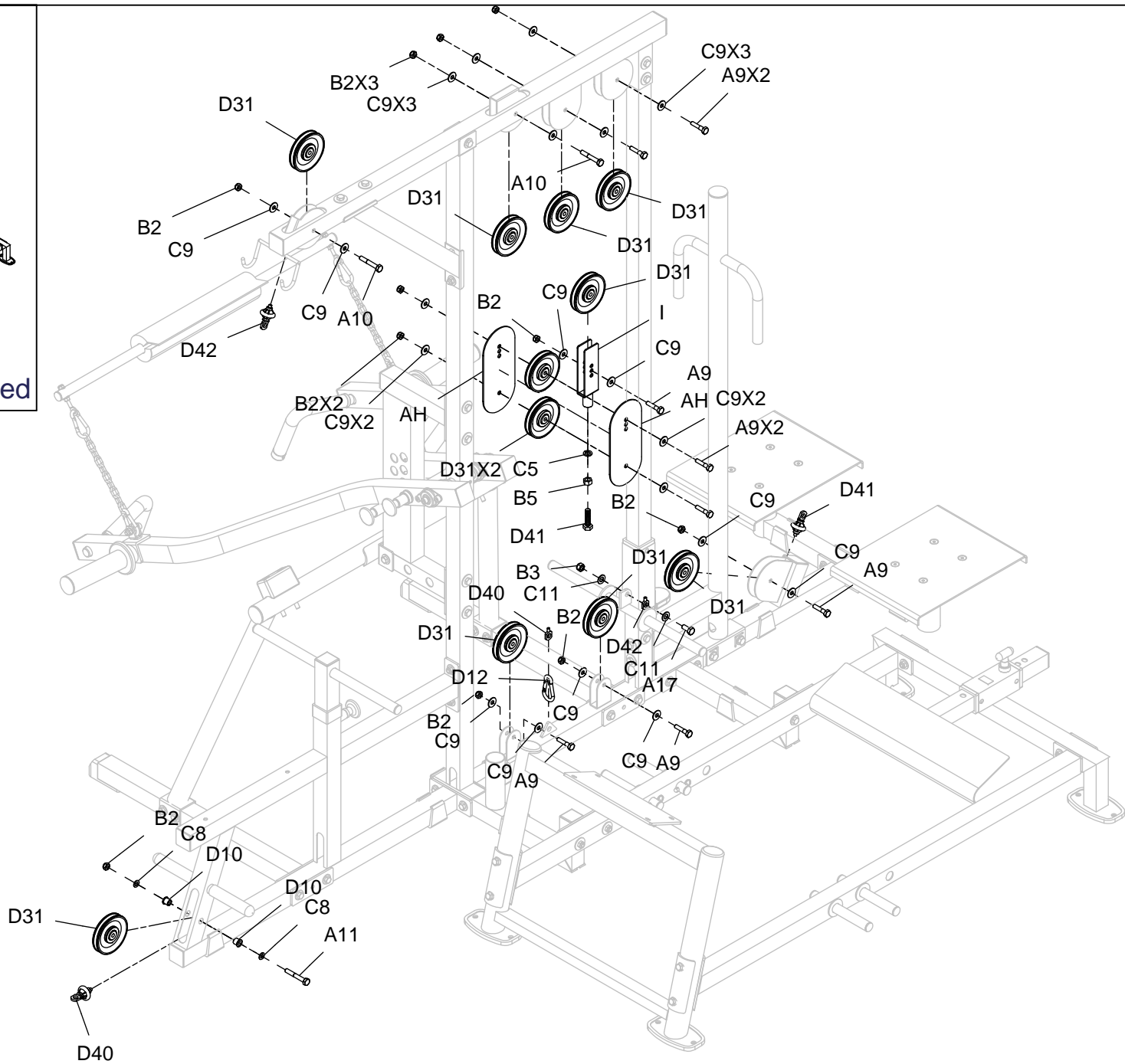
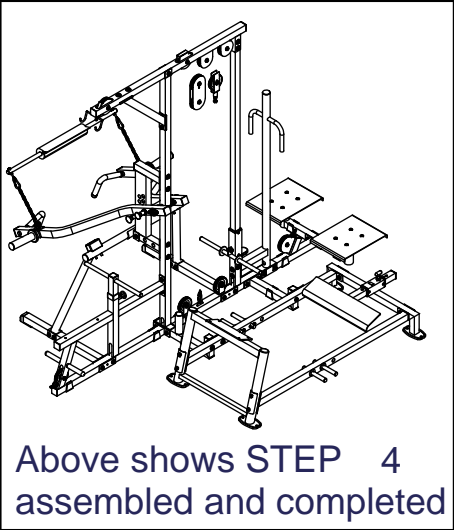

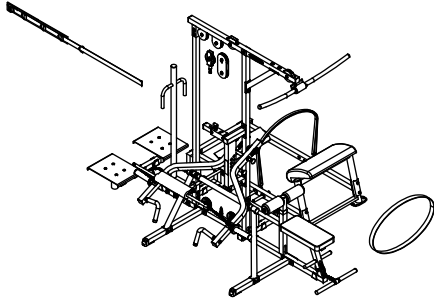

Above shows STEP 5 assembled and completed

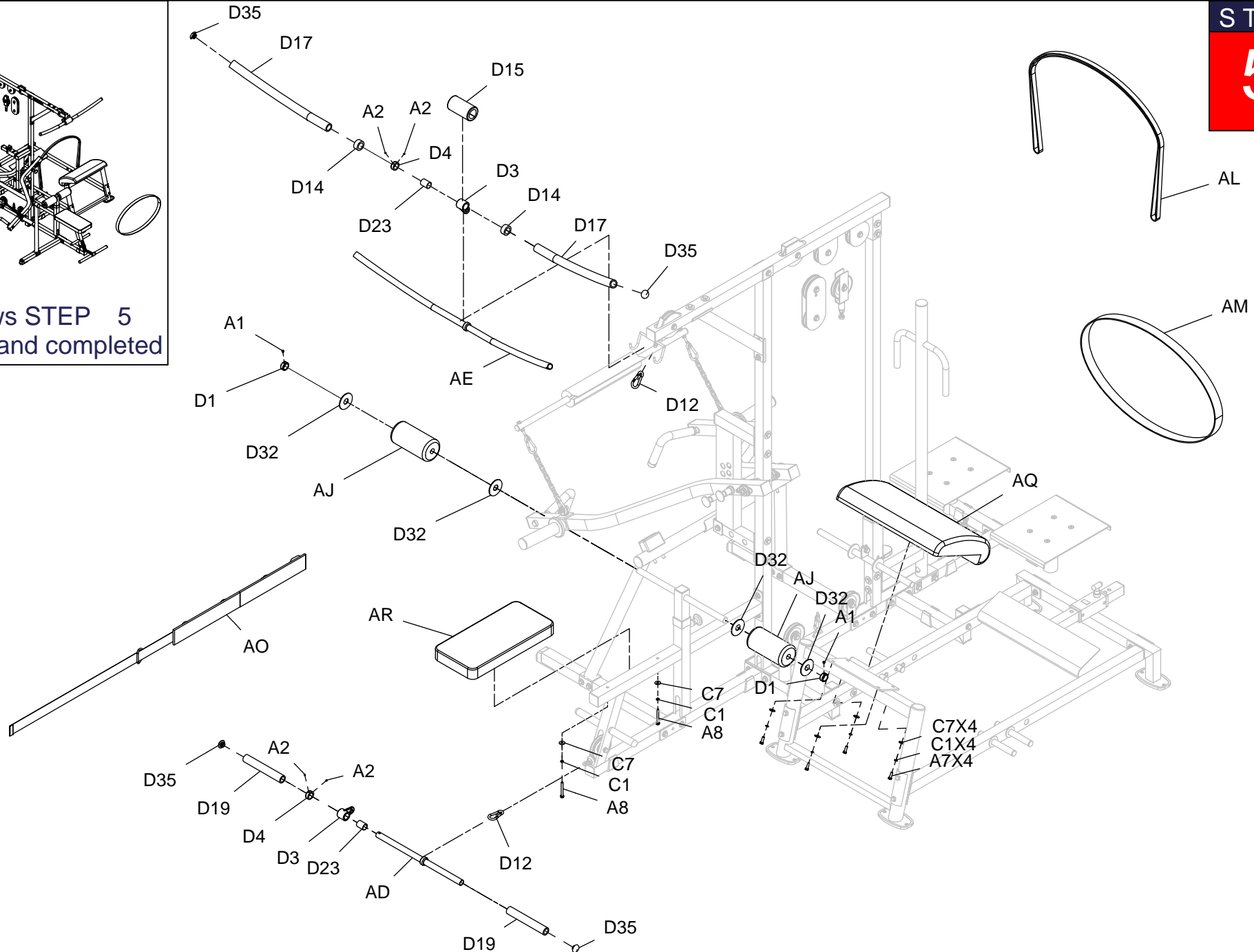



# CLPM3钢索示意图

