



The multi-rack RMR100A is ideal for garage gyms or home users, with its compact and versatile design allowing exercisers to strengthen almost the whole body in a shoe box! It features multiple add-ons, including power bars, a multi-grip pull-up bar, dip bars, and weight plate horns which make the RMR100A from a basic power cage to a functional machine.



RMR100A



RLA100



Frame Finish	One-coat powder process, electrostatically applied powder coat finish, Signal Black for RMR100A/RDP100/RLA100
Handgrips	Flexible Foam PVC Handle
Welding	Continuous welds at all joints
Drive wheel	Nylon with steel bearings
End Cap	High density molded plastic end cap
Cables	7x19 stainless steel ,tensile strength Cables 1984lbs/ 900kg for RLA100
Dimensions	1902 x1160 x 2250 mm / 74.8"X45.6"X88.6"

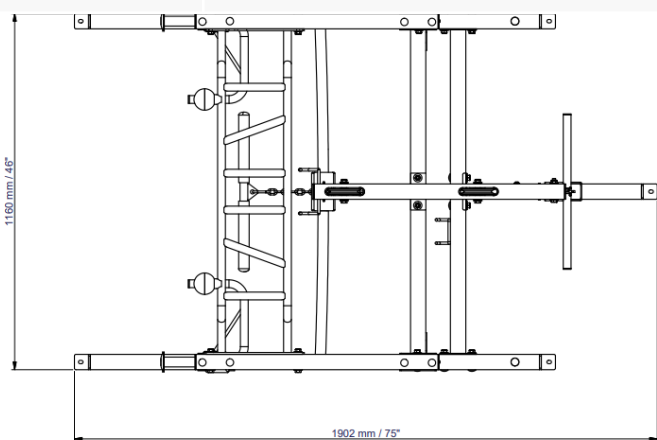

Floor Space Dimensions:L1902 x W1160 x H2250 mm



INTERNATIONAL
 3F28, No. 5, Shin-Yi Rd., Sec. 5, Taipei ,Taiwan110
 Tel:+886-2-2720-9980
 Fax:+886-2-2722-9750
 E-mail:joong@ms13.hinet.net
<http://www.steelflexfitness.com>